

Pickup Box Tiered Storage Bar Package Installation

Installation Instructions Part Number

85150890

Kit Contents

Qty	Description
1	Right Hand Plastic Base
1	Left Hand Plastic Base
1	Right Hand Plastic Base Foam
1	Left Hand Plastic Base Foam
2	Cross Rail Assembly
4	M6 Bolts w/ Countersink
4	M8 J-NUT WIDE RANGE
4	M8 J NUT NARROW NECK
12	M8 BOLT
4	M8 WASHER
2	M6 Hex Key
1	Installation Instructions

Tools Required

Drill/ 9mm Drill Bit

Suitable Cutting Tool

M8 Wrench

M8 Socket

T-30 Torx

Procedure

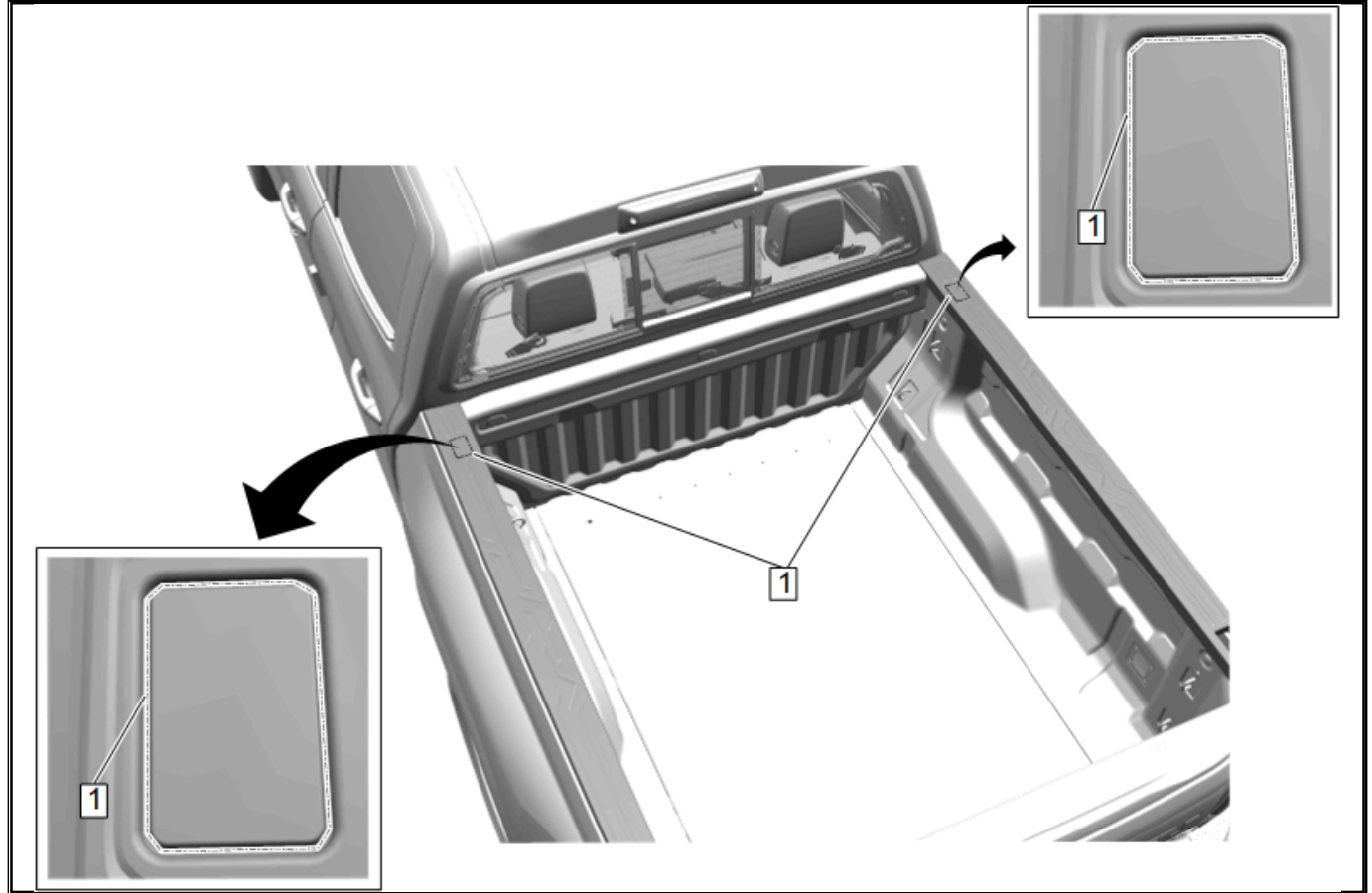

1. Using a suitable cutting tool, cut out bed cap docking station location plastic (1) at two openings following grooved perimeter.
2. Clean the pickup box trim moldings and underside of plastic bases before installing base foam.

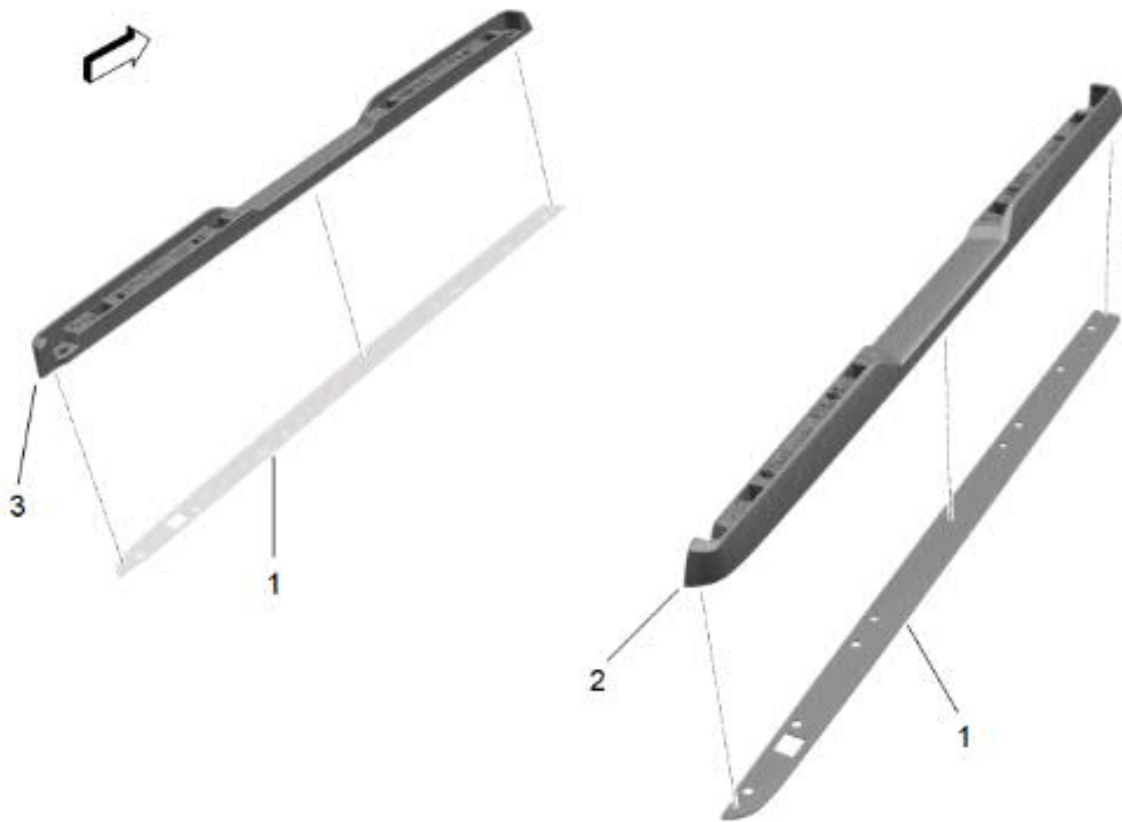

3. Install the base foam pieces (1), starting from one end to the middle and then install the second piece from the middle to end to the correct LH (3) and RH (2) bases.

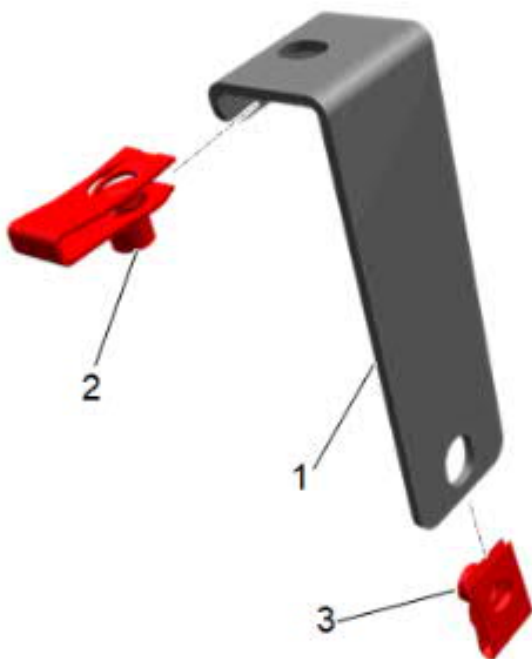

4. Assemble the rear bracket (1). Using the wide range J-nut (2) for the top part of the bracket, and the narrow neck J-nut (3) for the bottom. Repeat step for other rear bracket.

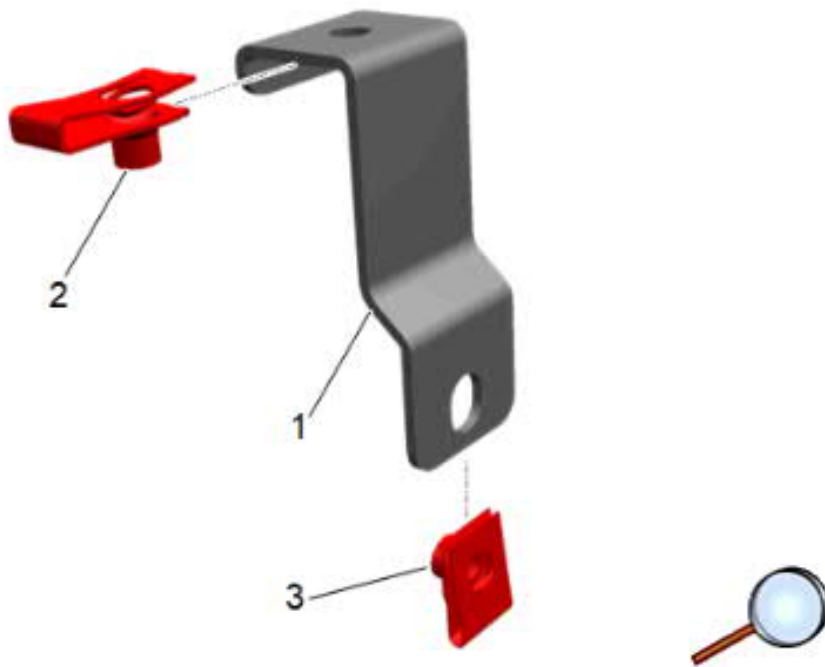

5. Assemble the front bracket (1). Using the wide range J-nut (2) for the top part of the bracket, and the narrow neck J-nut (3) for the bottom. Repeat step for other front bracket.

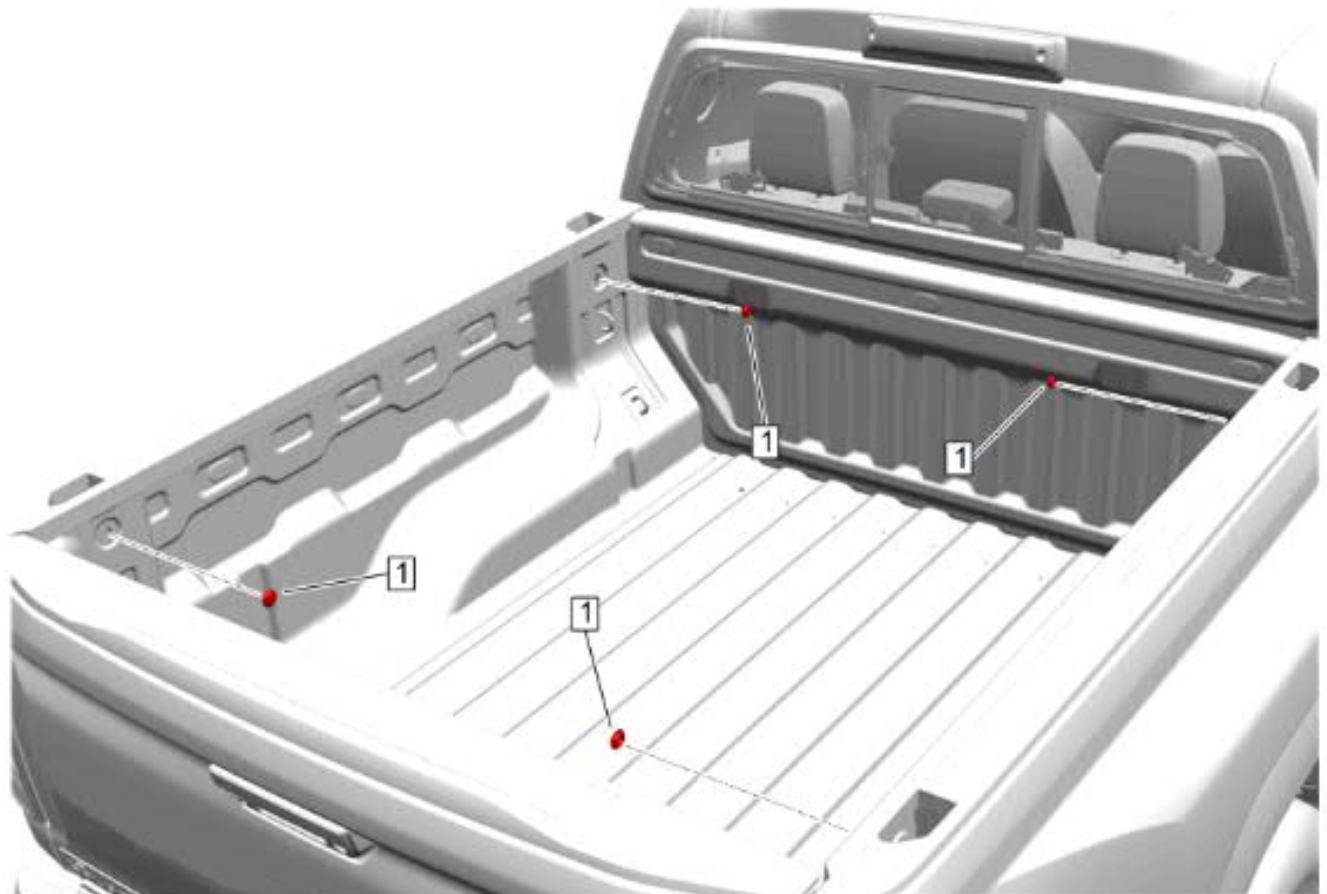

6. Remove the four rubber plugs (1) from the pickup box.

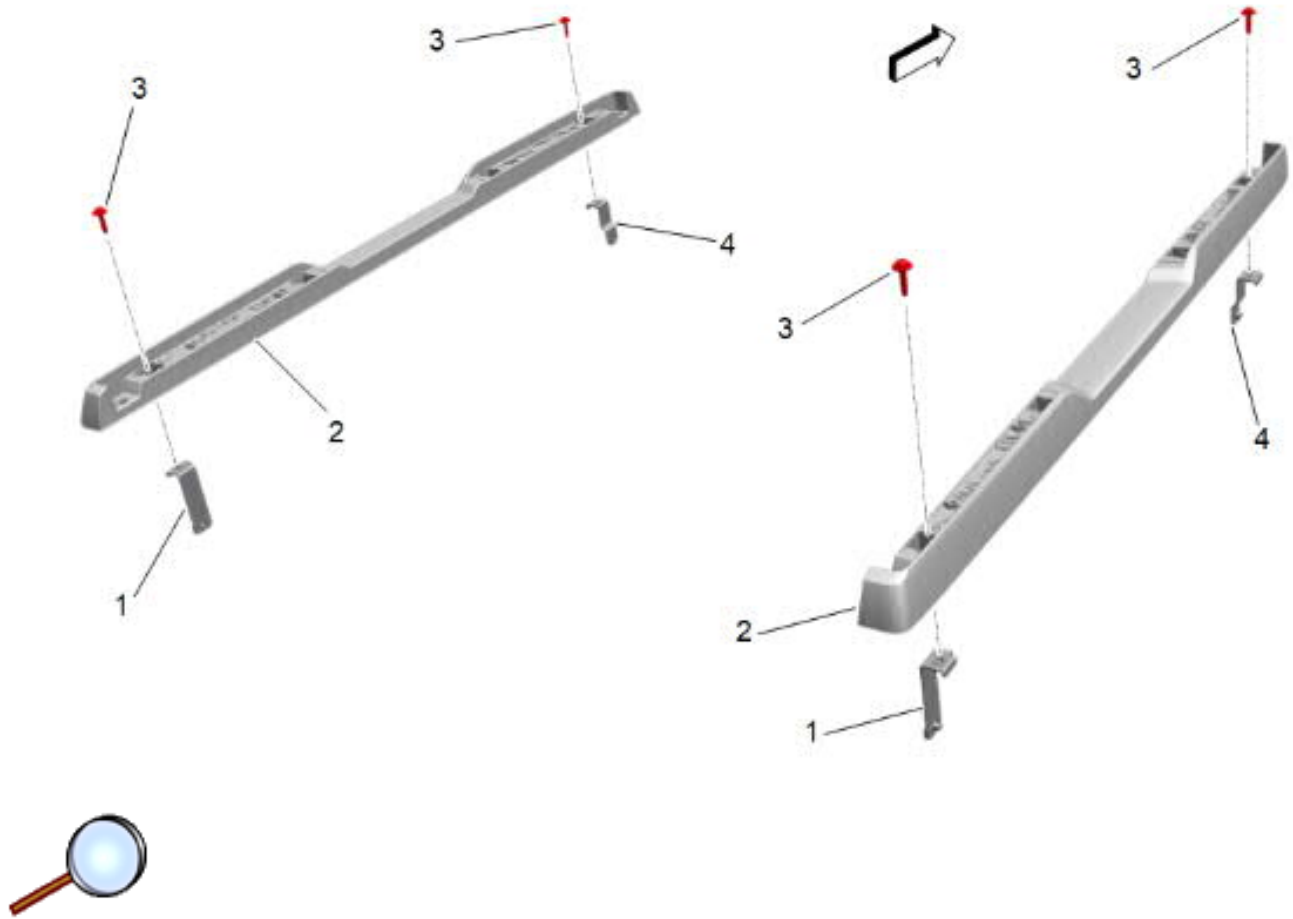

Caution: Use the correct fastener in the correct location. Replacement fasteners must be the correct part number for that application. Fasteners requiring replacement or fasteners requiring the use of thread locking compound or sealant are identified in the service procedure. Do not use paints, lubricants, or corrosion inhibitors on fasteners or fastener joint surfaces unless specified. These coatings affect fastener torque and joint clamping force and may damage the fastener. Use the correct tightening sequence and specifications when installing fasteners in order to avoid damage to parts and systems.

Note: The bases (2) have a sticker on them to identify the driver side and passenger side.

Note: The bent shape bracket (4) installs towards the front and the straight bracket (1) installs to the rear. All brackets should have the mount surface face towards the bed of vehicle.

7. Install front (4) and rear (1) brackets into the bases (2). Install the M8 bolts (1) and washers (2) to the brackets. Install the M8 bolts (3) to secure brackets, do not torque M8 bolts at this time.

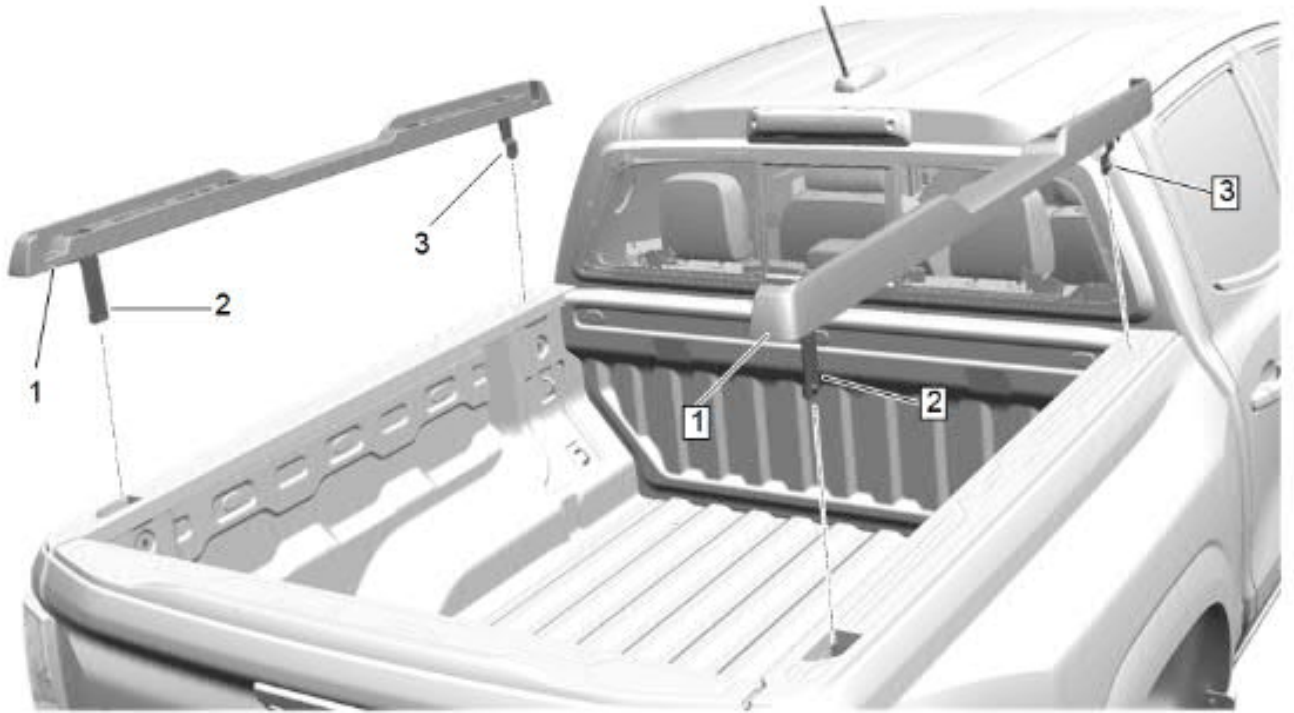

8. Place the bases (1) to the appropriate side of the vehicle making sure that the brackets (2), (3) are orientated correctly.

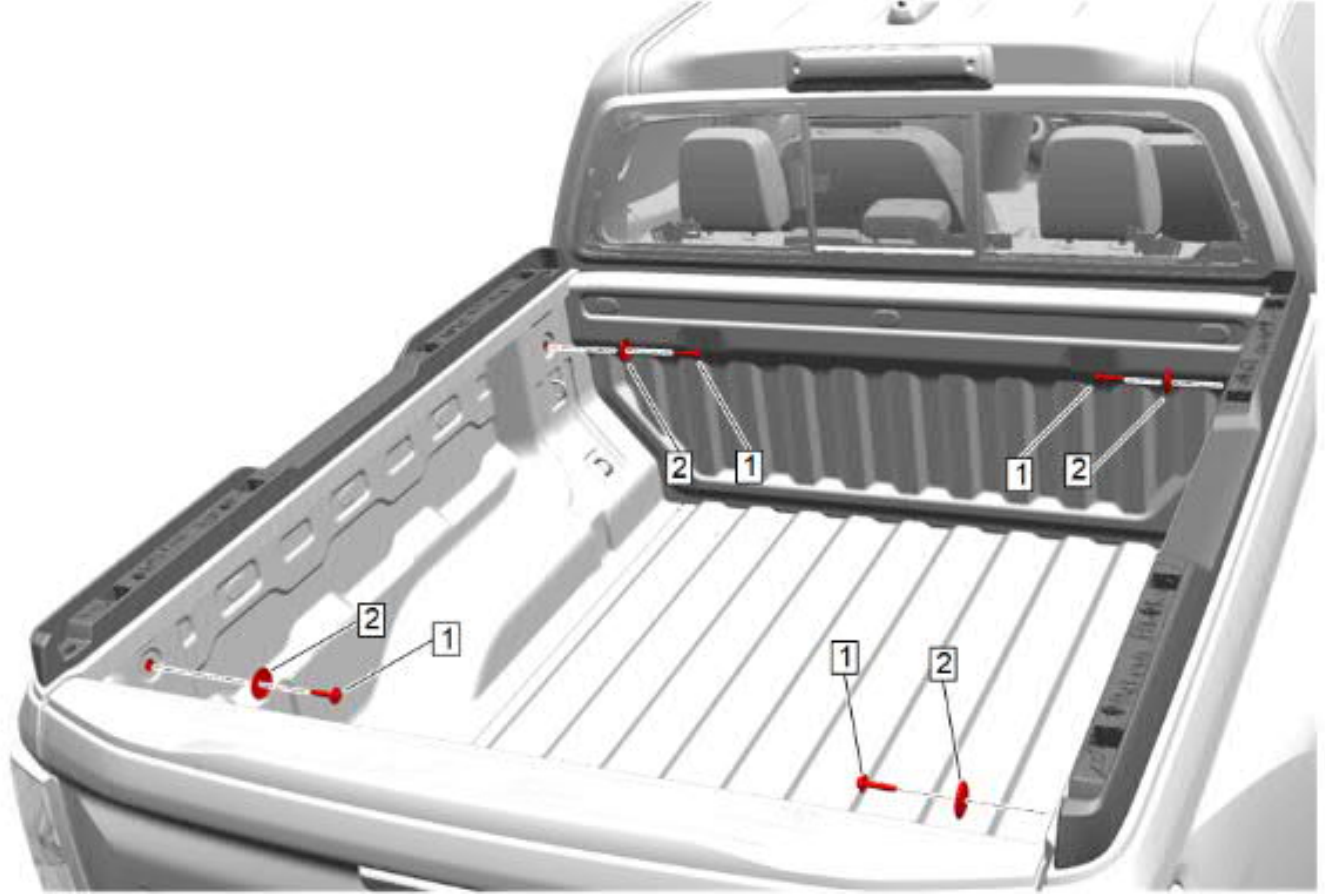

9. Install the M8 bolts (1) and washers (2) to the brackets. While pulling down on the bases tighten the M8 bolts (1) to 9 N.m (7 lb ft).

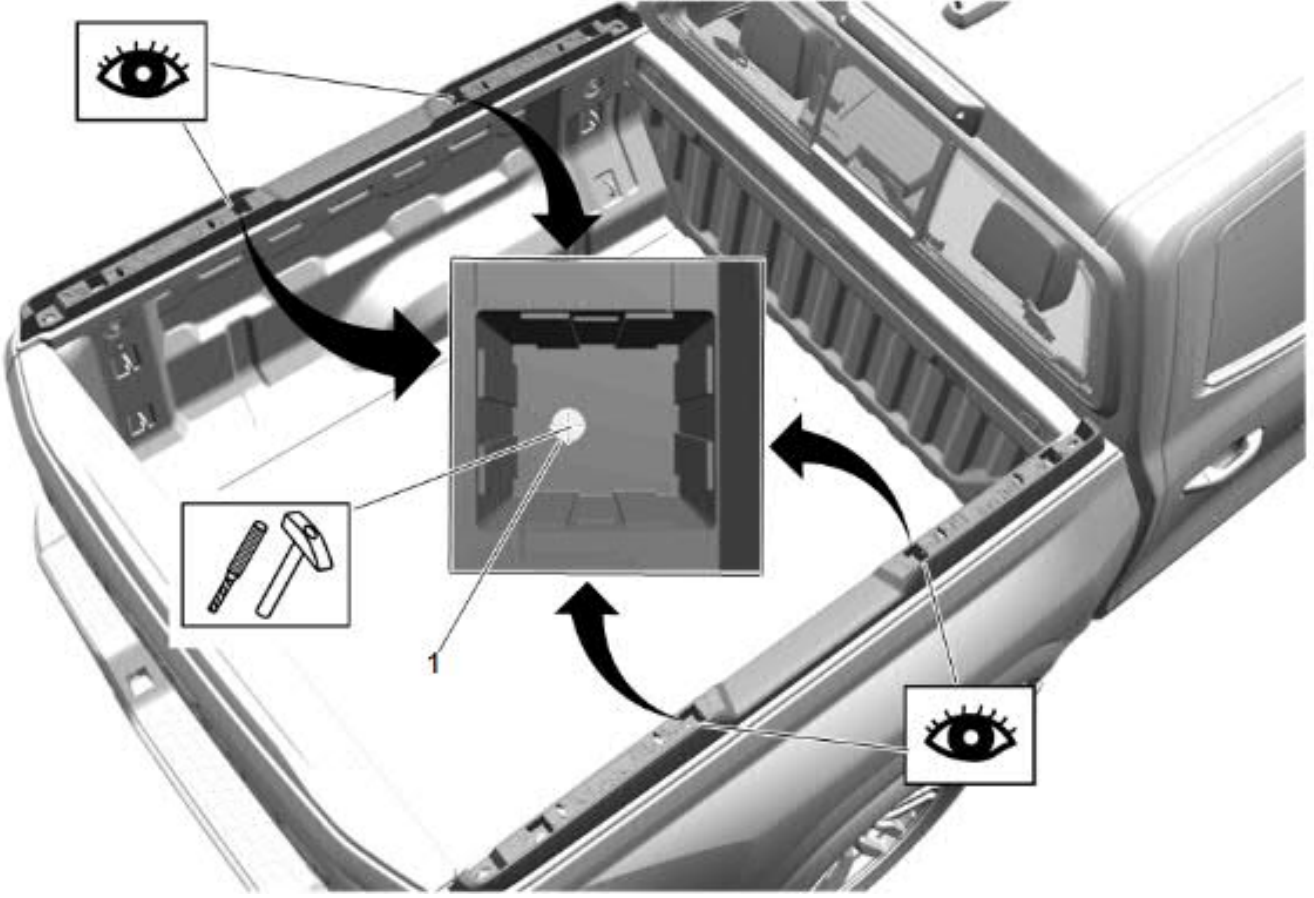

10. Identify the four locations (1) where part will mount to the pickup box. Center punch each location (1).

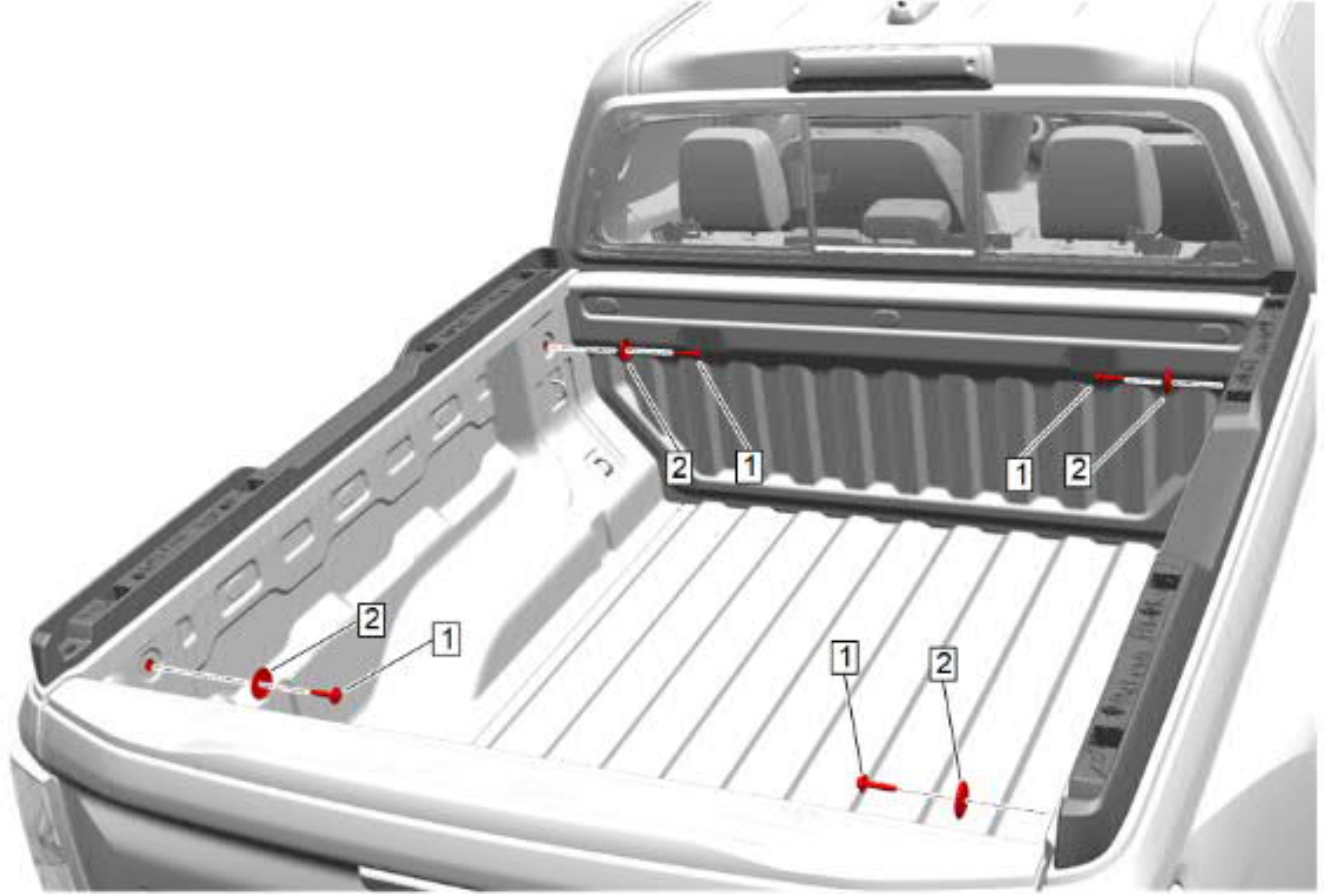

11. Remove the M8 bolts (1) and washers (2) from the brackets.

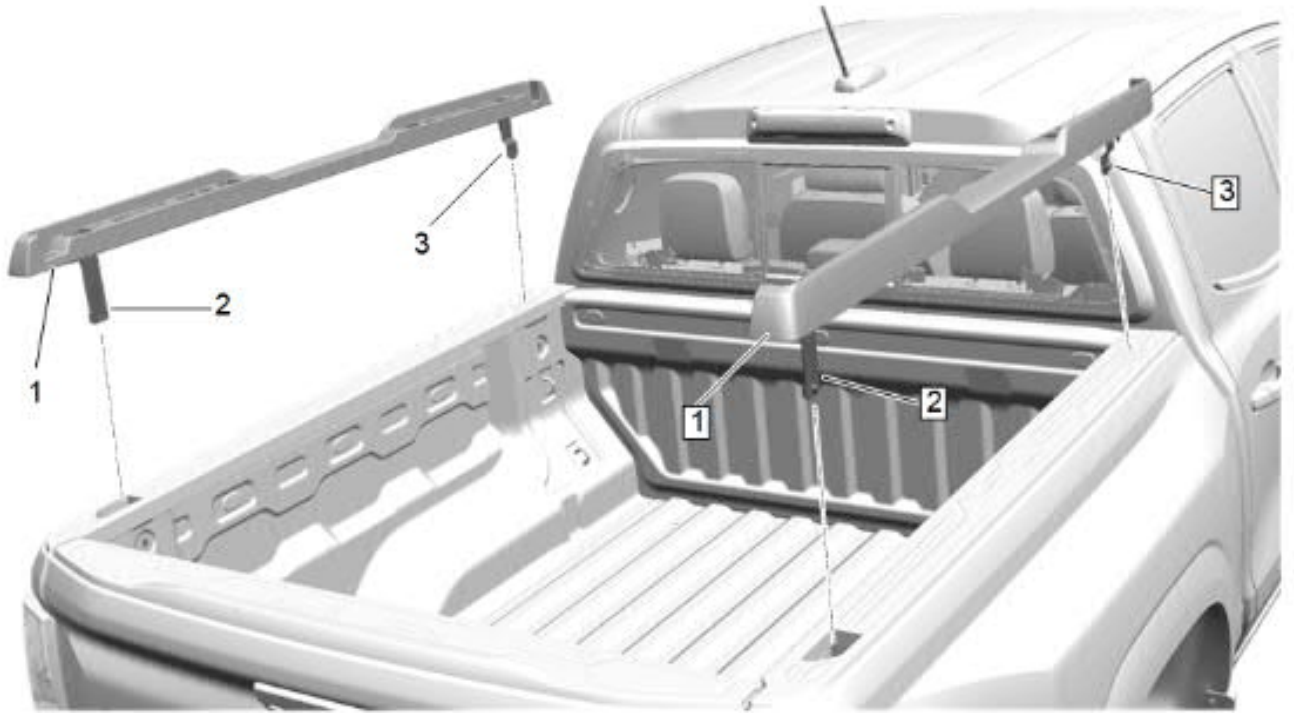

12. Remove the bases (1) with bracket (2), (3) from the vehicle.

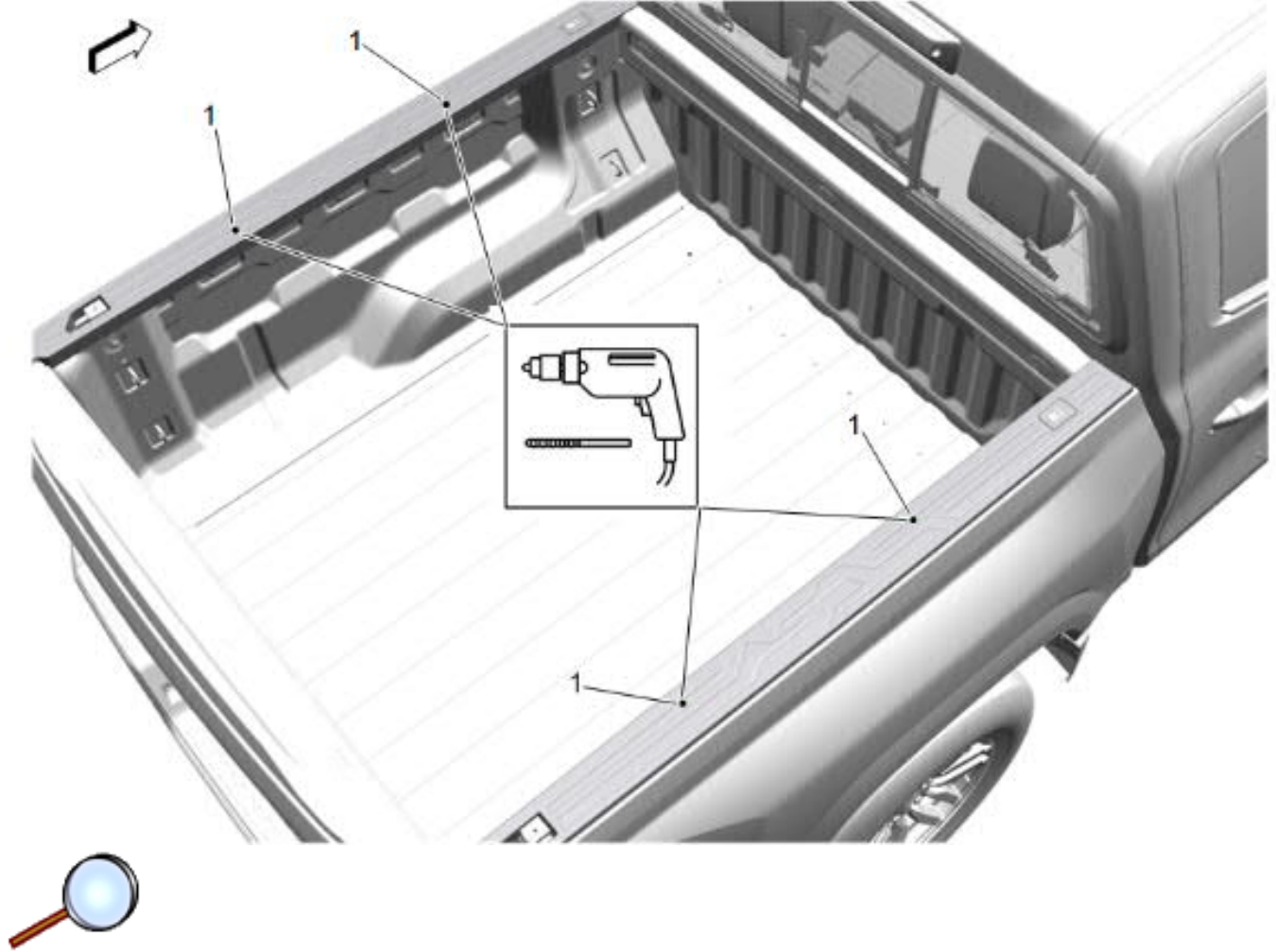

Note: Do not drill into the box with the rails on the vehicle.

Caution: Always check scale, size and position of holes before drilling. Failing to do so may cause damage to the vehicle, misalignment of components or the inability to install the accessory.

13. Using a 9mm drill bit, drill out the center punched holes (1). Apply corrosion protection to the sheet metal of drilled holes.

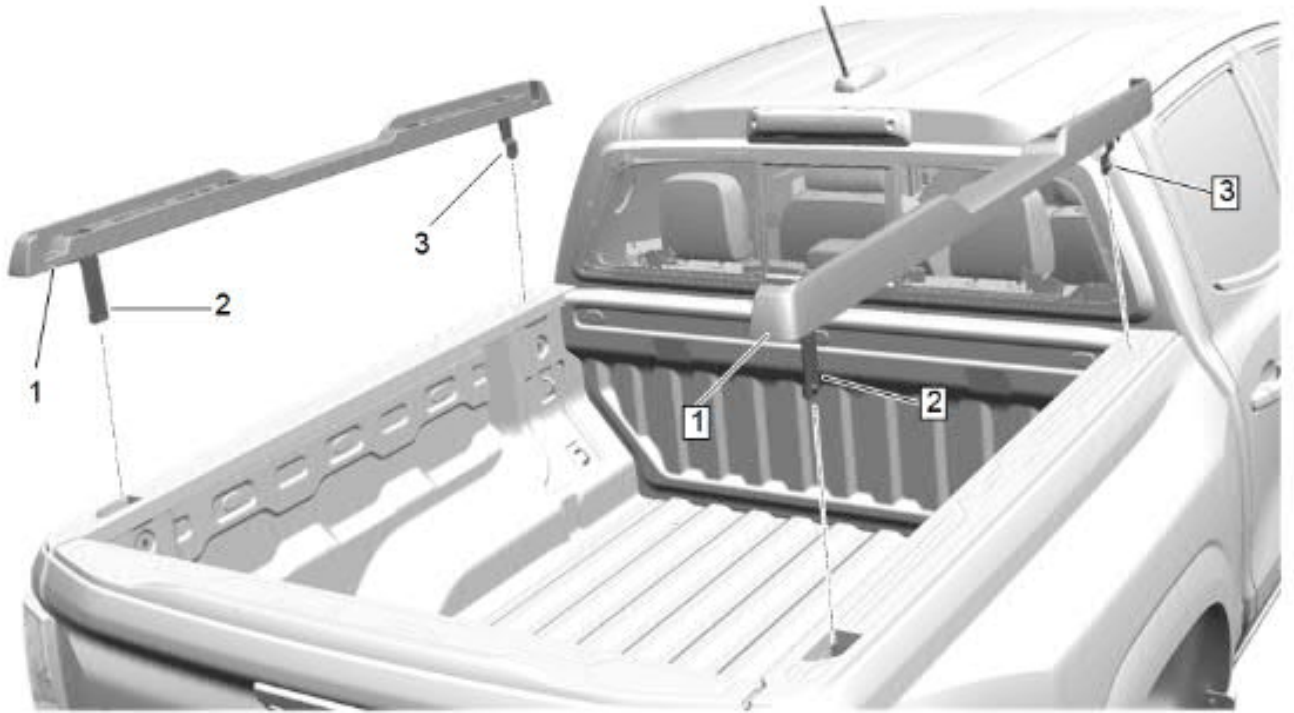

14. Place the bases (1) to the appropriate side of the vehicle making sure that the brackets (2), (3) are orientated correctly.

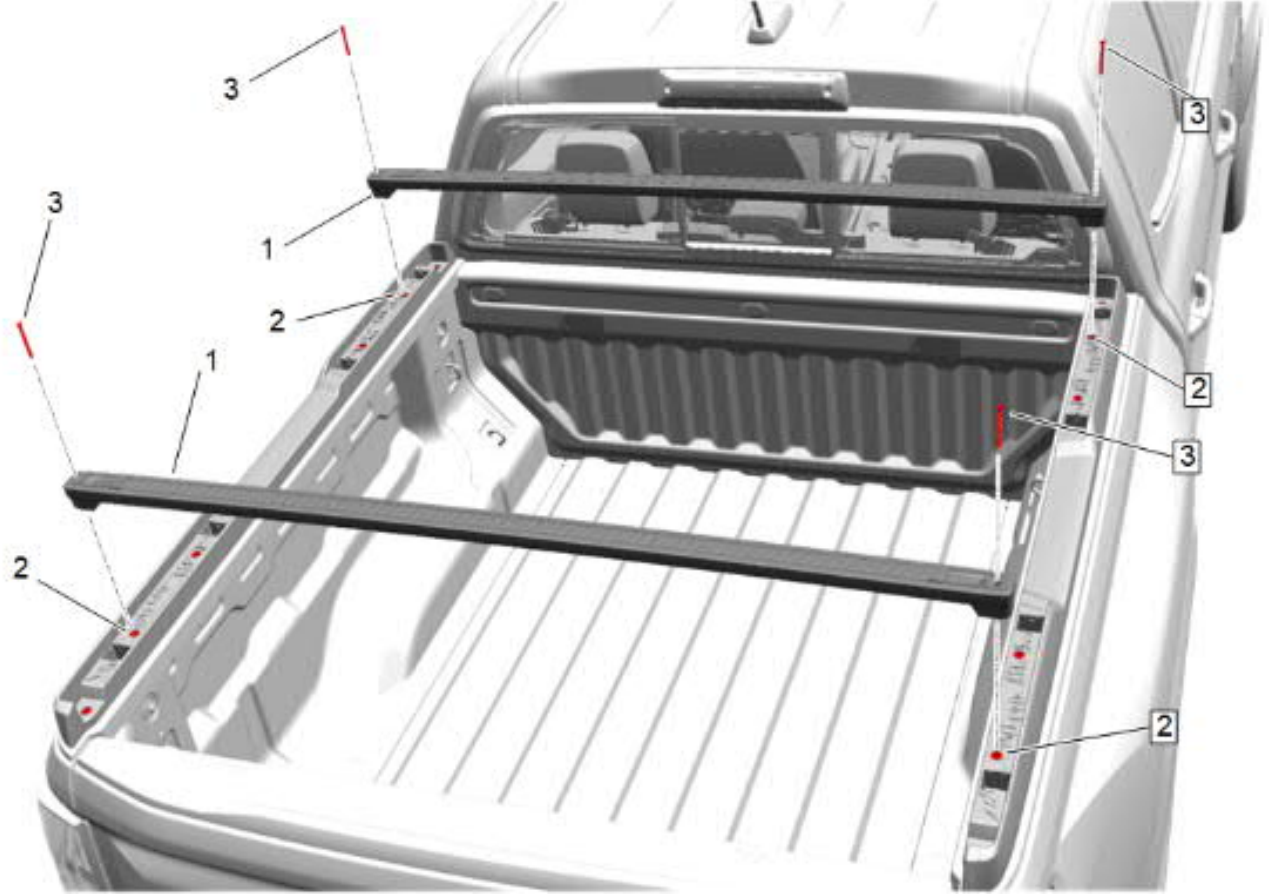

15. Install the cross rails (1) to the outer most mounting positions (2) of the bases. Secure the cross rails to the base with the countersunk M6 screws (3). Hand tighten the M6 screws with the supplied M6 hex key.

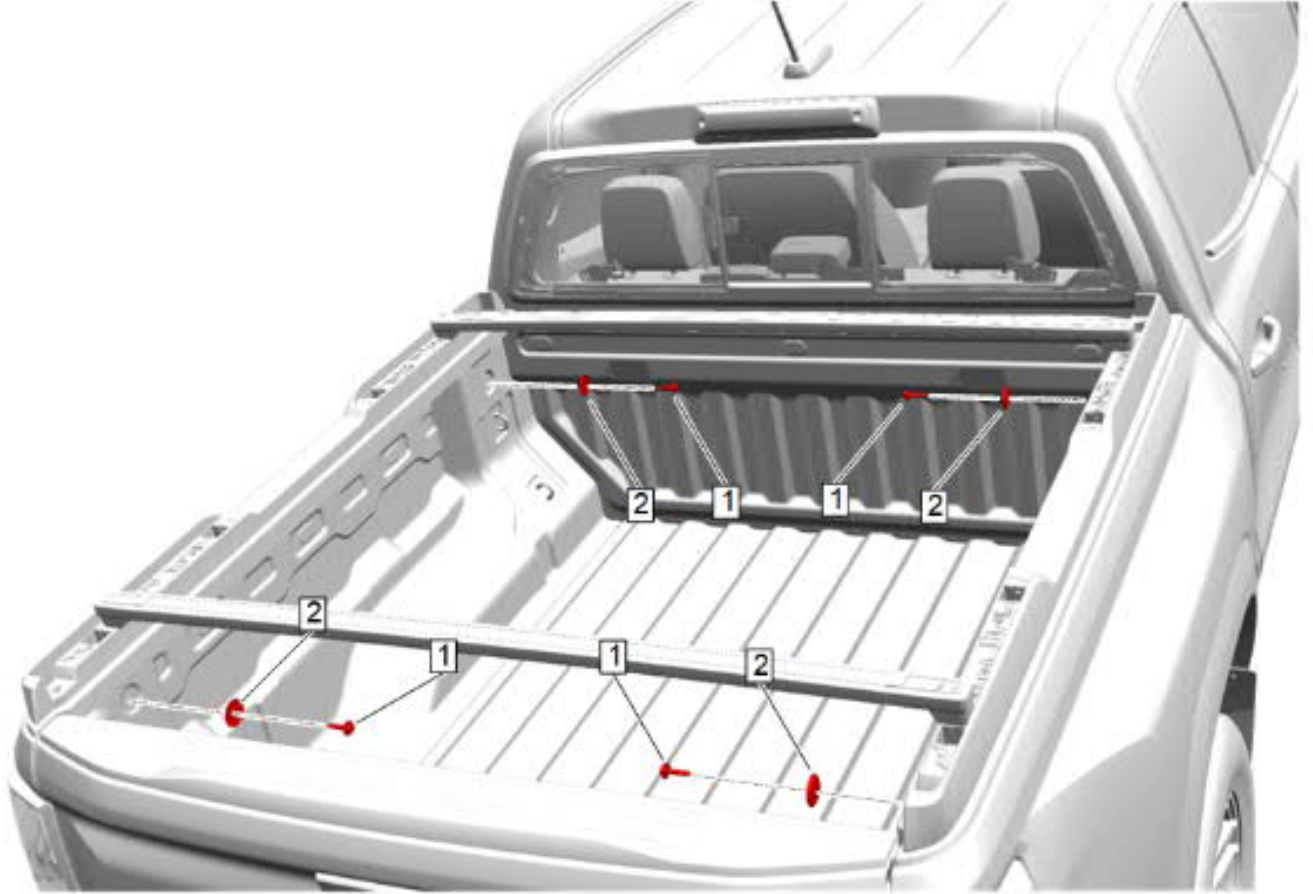

16. Install the M8 bolts (1) and washers (2) to the brackets. While pulling down on the bases tighten the M8 bolts (1) to 22 N.m (16 lb ft).

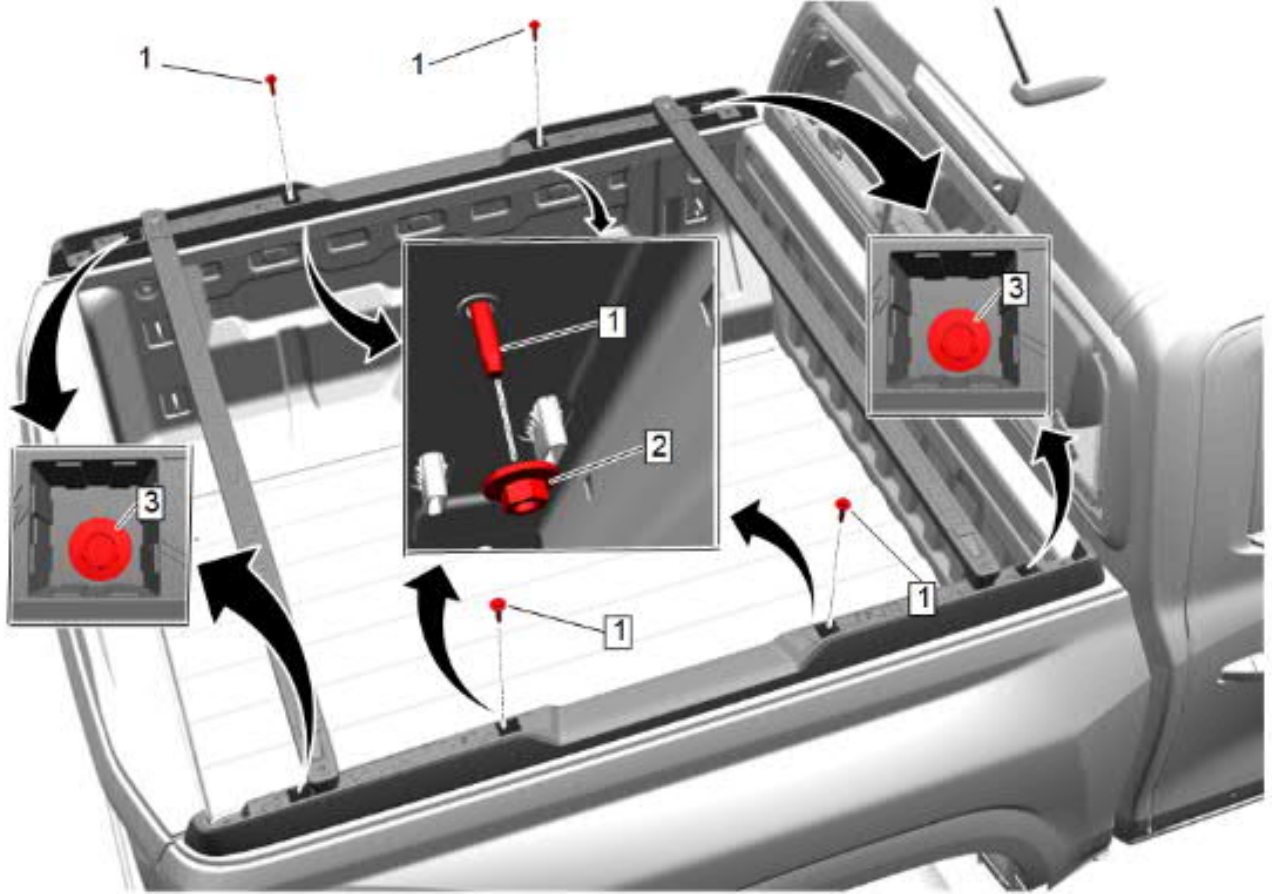

17. Install the M8 bolts (1) to the center of rails and install the M8 nuts (4) to center M8 bolts (2). Tighten the M8 bolts and nuts to 9 N.m (7 lb ft).
18. Tighten the M8 bolts (3) to the corners of the rails to 9 N.m (7 lb ft).

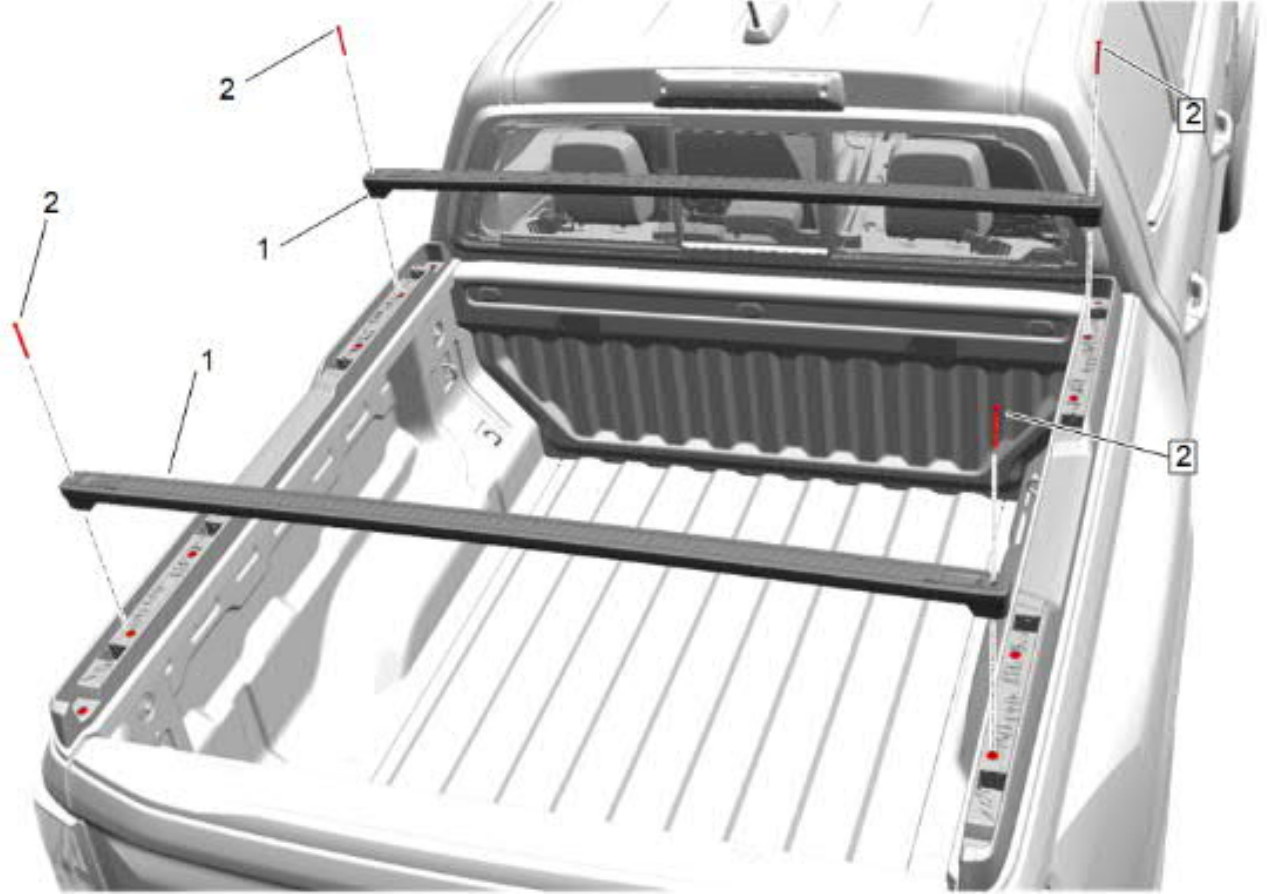

19. Remove the countersunk M6 screws (2) and cross rails (1) and set aside.

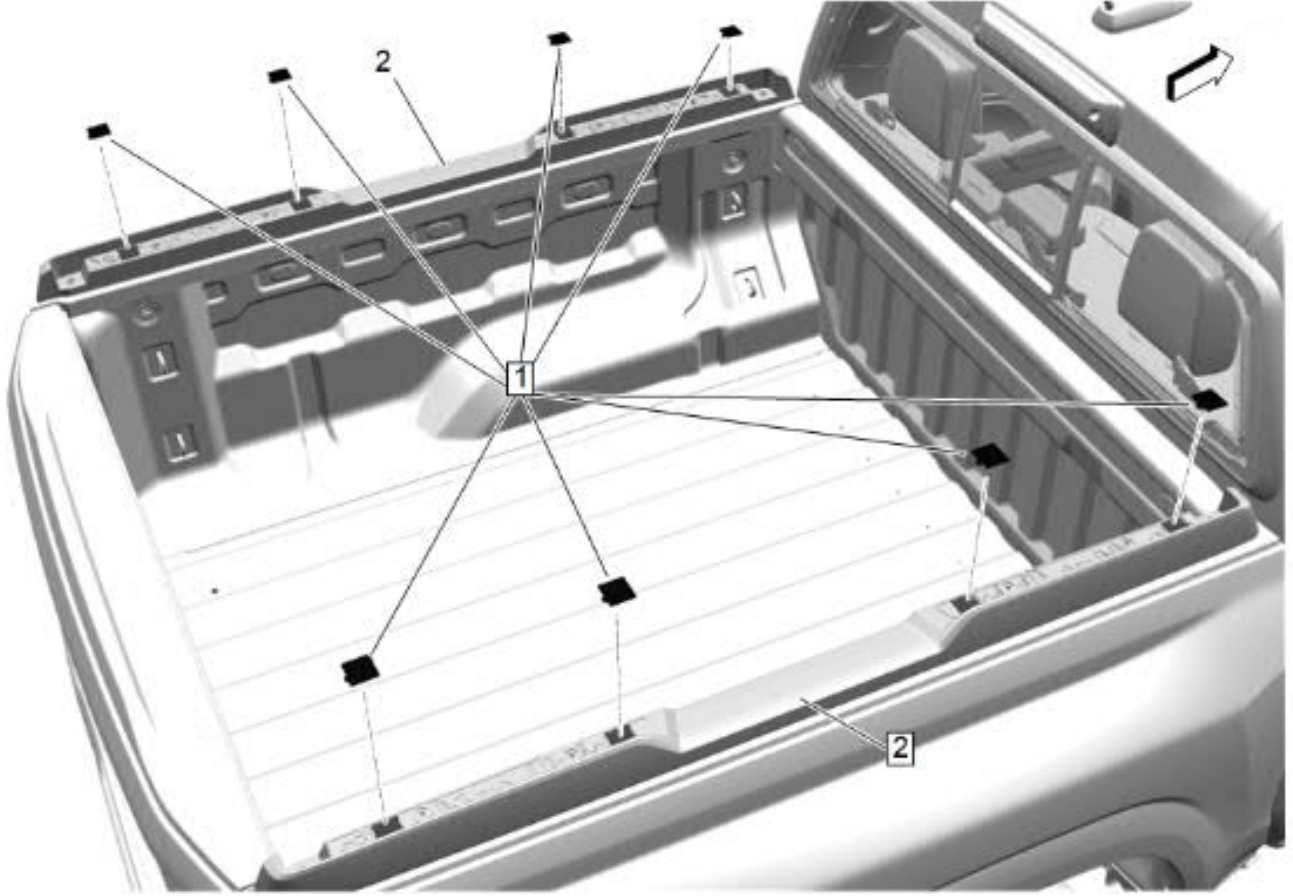

20. Install the cap covers (1) to the rails (2), making sure they snap into place.

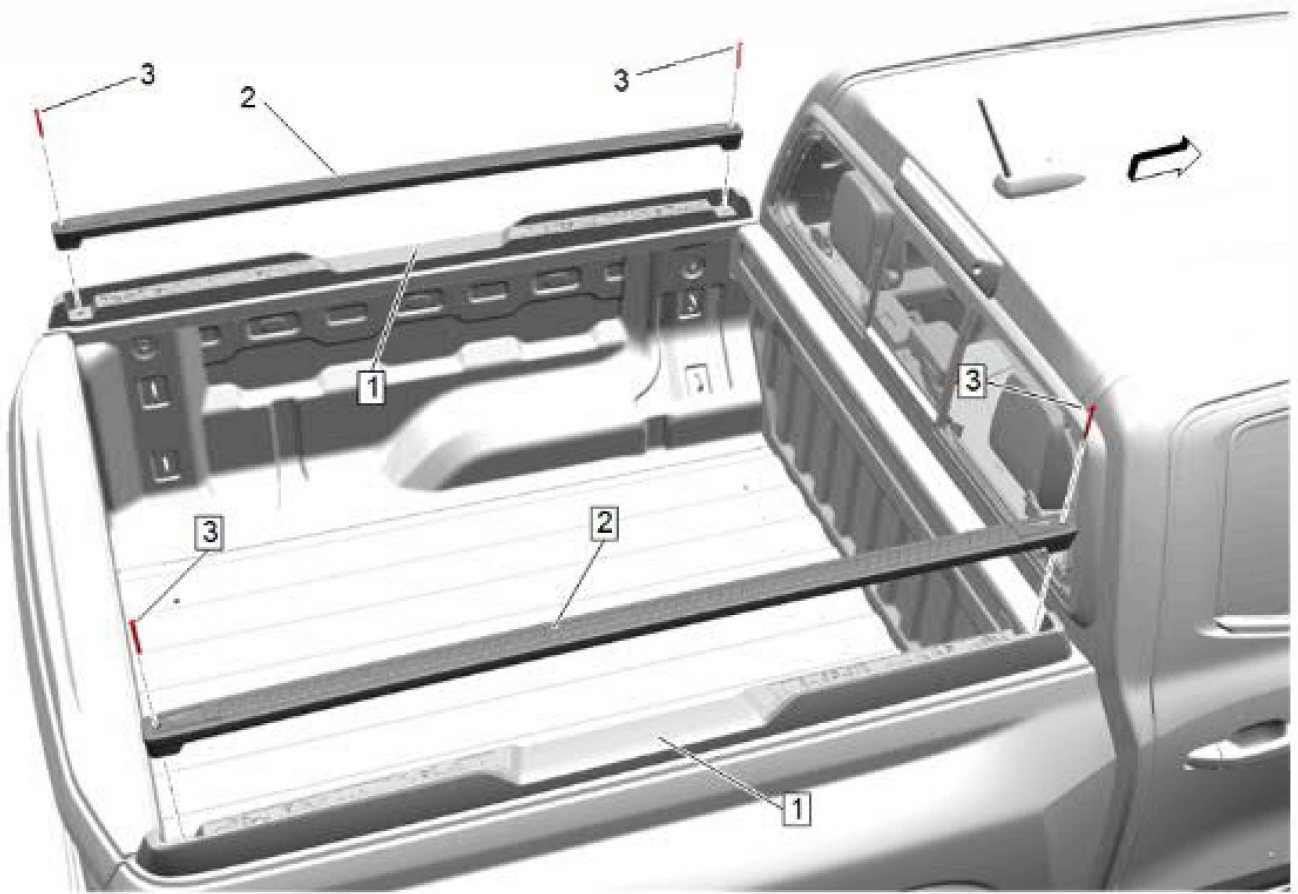

21. Place the cross rails (2) onto the base (1) in the stowed position. Secure the cross rails to the base with the countersunk M6 screws (3). Hand tighten the M6 screws with the supplied M6 hex key.

Note: Place the M6 hex key in storage compartment of vehicle where customer can find.

Cross Rail Positions

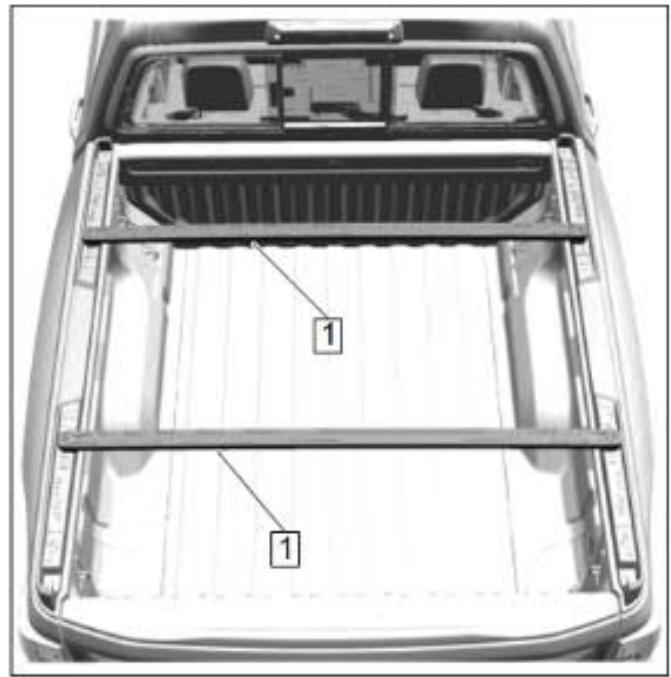

Cross rails (1) can be mounted in four locations.