

## Installation Instruction Part Number

84328135

## Kit Contents

QTY.	Description
1	Mirror Housing Cover – LH
1	Mirror Housing Cover – RH
1	Installation Instructions

## Procedure

### Remove Production Mirror Housing Cover

**Warning:** *Approved safety glasses and gloves should be worn when performing this procedure to reduce the chance of personal injury.*

1. Place masking tape over the mirror glass.
2. Apply several layers of masking tape to the mirror lower housing edge to protect the finish.

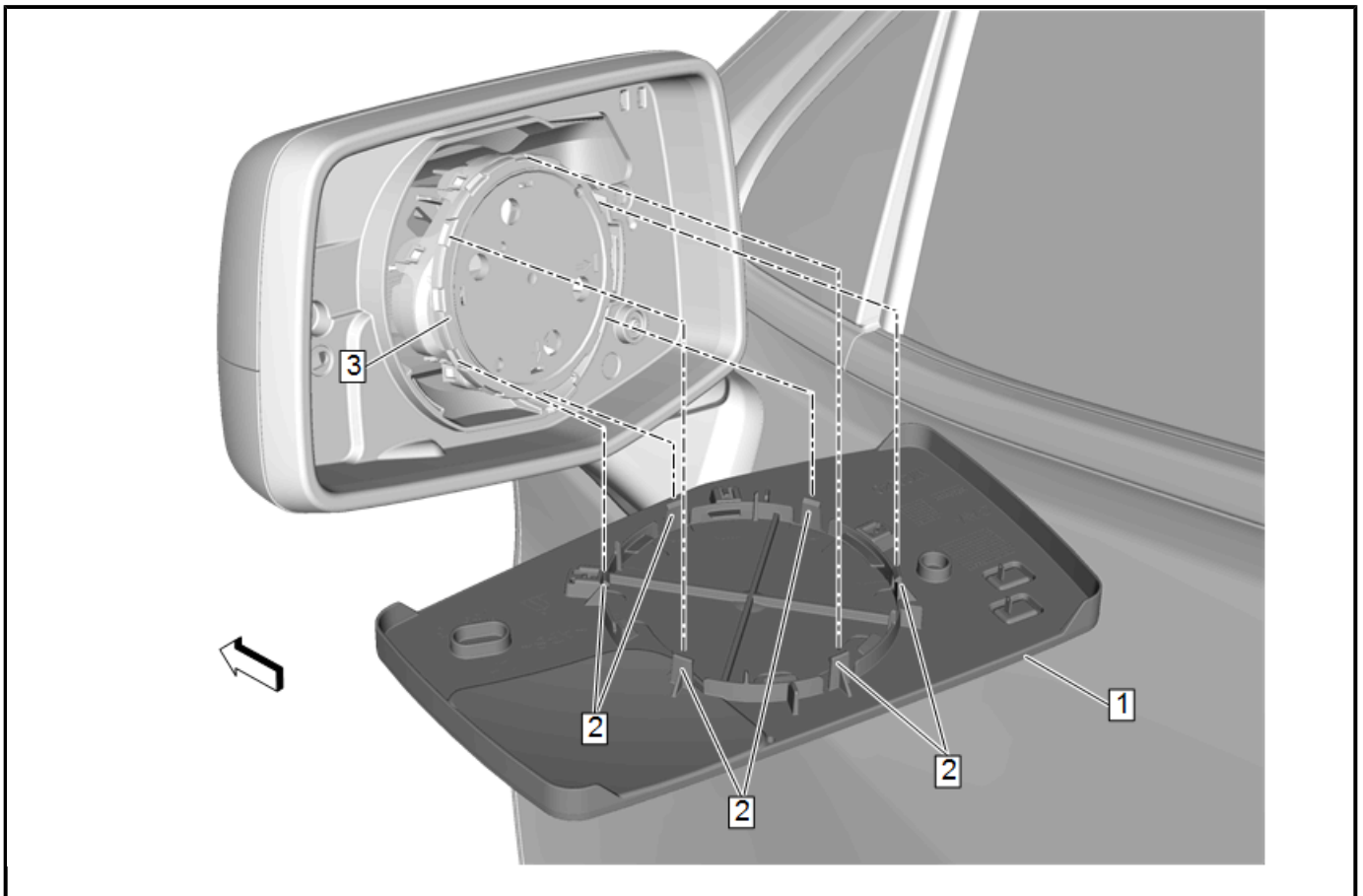

4986394

**Note:** The motor/actuator ring (3) must stay with the motor/actuator, not with the mirror glass (1).

3. Remove the mirror glass as follows:
  - 3.1. Place the mirror face flat to the housing.

- 3.2. Insert the suitable tool between the mirror lower housing edge and the lower edge of the mirror glass.
- 3.3. Holding the tool in place, press upward on the glass (1) to release the tabs (2) from the motor/actuator ring (3).
4. Disconnect the electrical connectors.

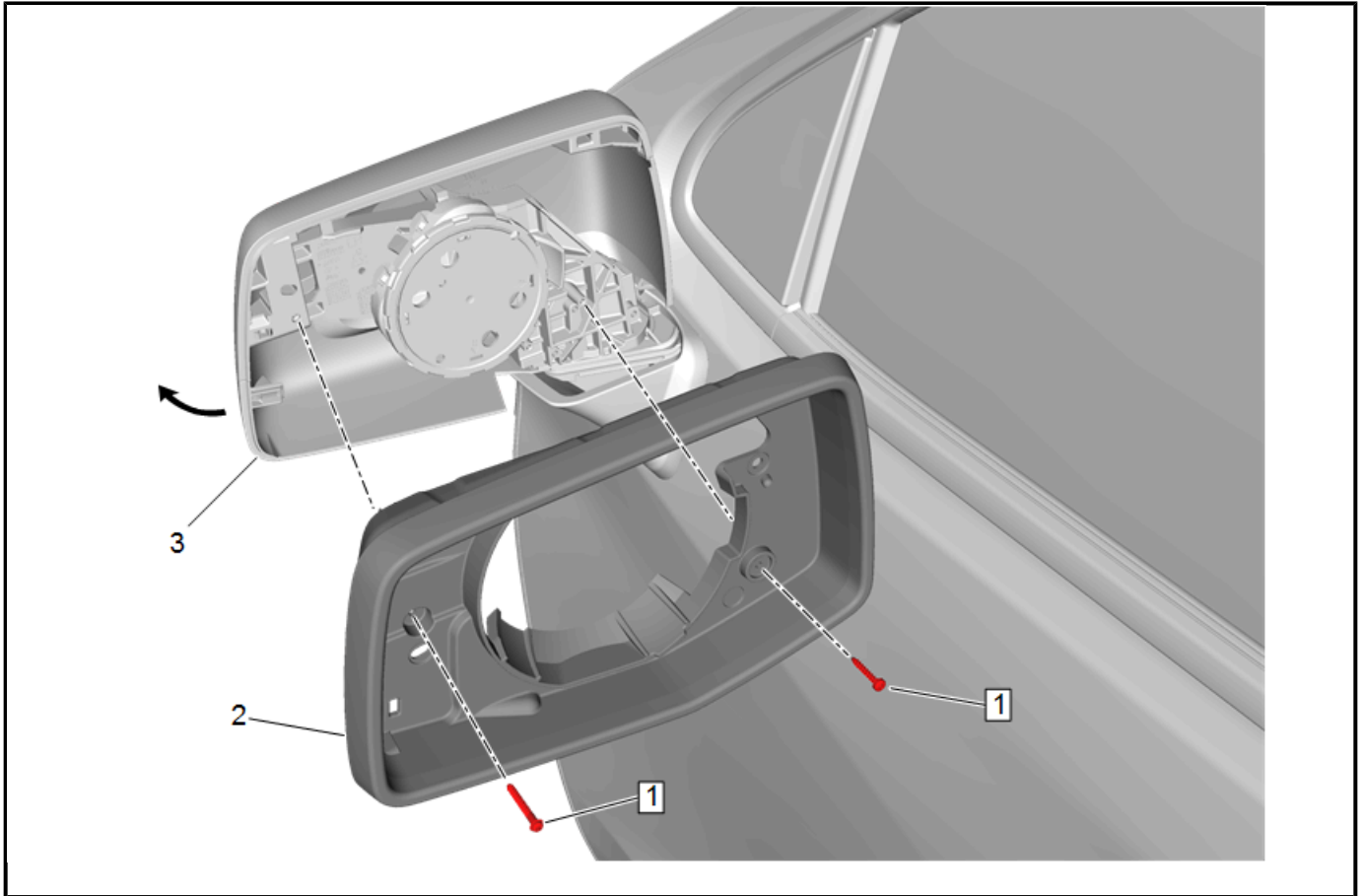

4986395

5. Rotate the mirror housing (3) forward to the vehicle so that it helps removal of the bezel.
6. Remove and retain the two screws (1) that secure the bezel.
7. Remove the bezel (2) from the mirror housing (3).

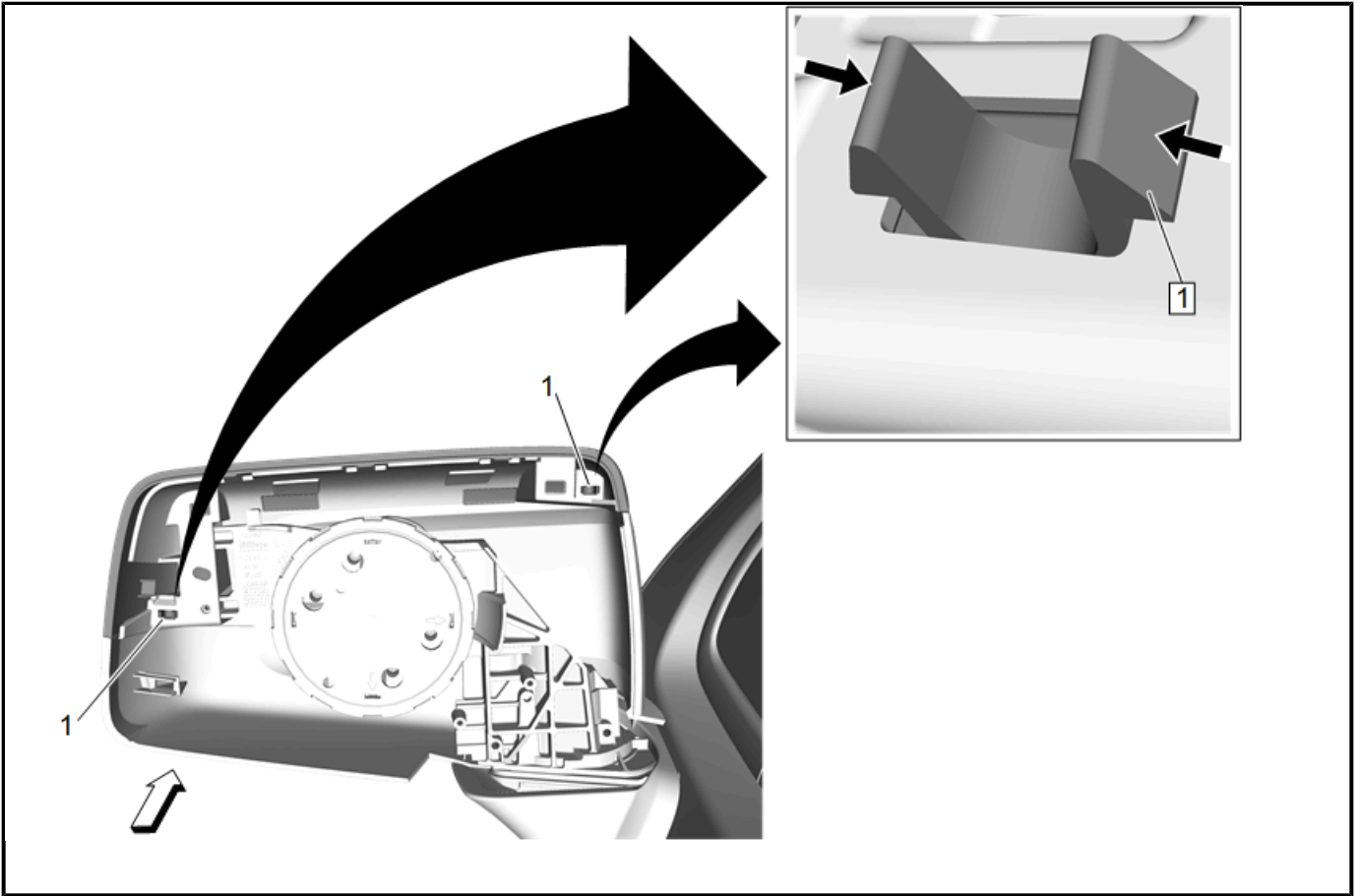

4986397

8. Depress the two retaining tabs (1) on the mirror cover.

**Note:** The retaining tabs may break during this process which is normal.

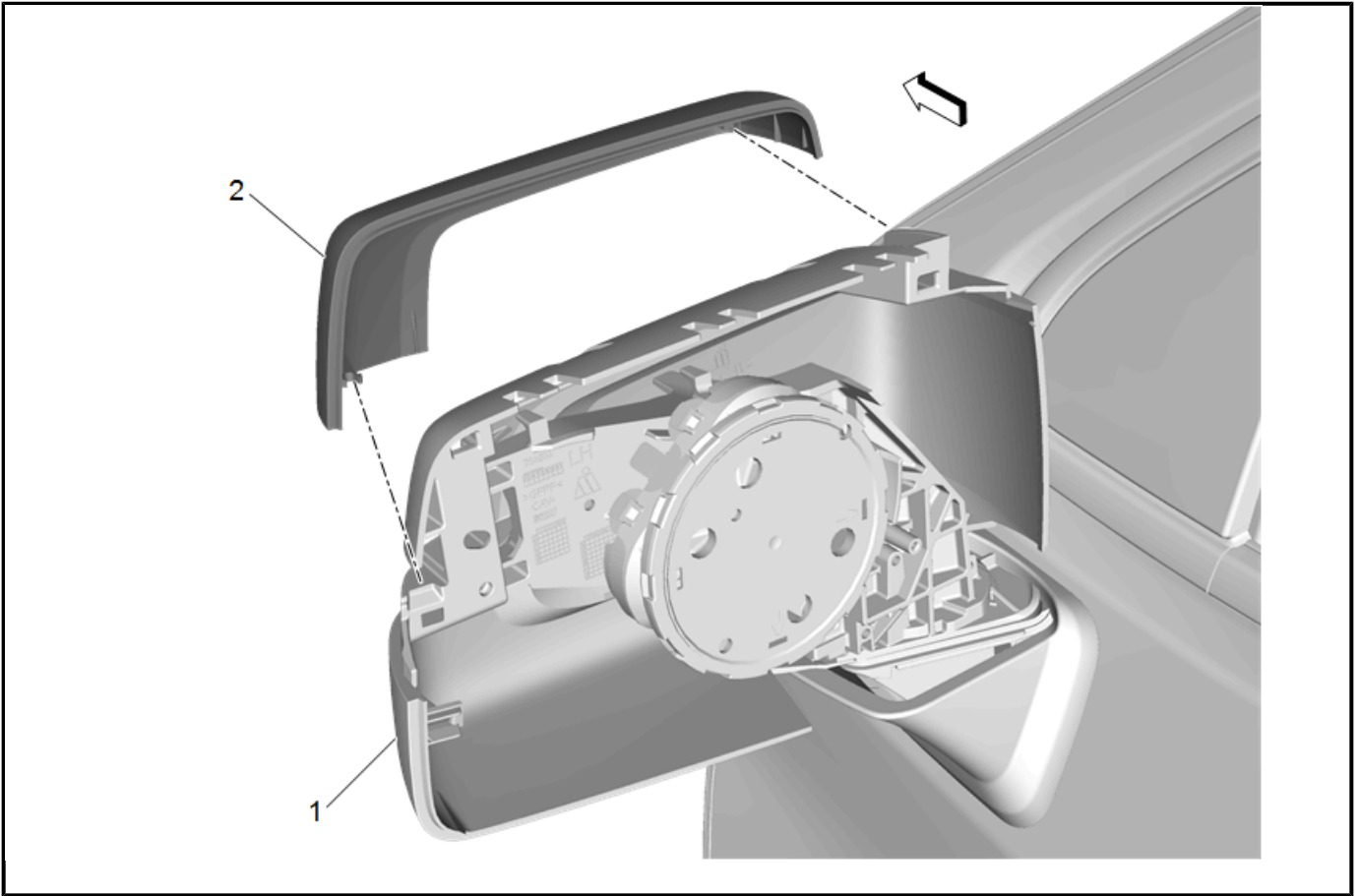

4986399

9. Grasp mirror housing cover (2) and lift outwards from the mirror housing (1) to release the retainers.

## Install New Mirror Housing Cover

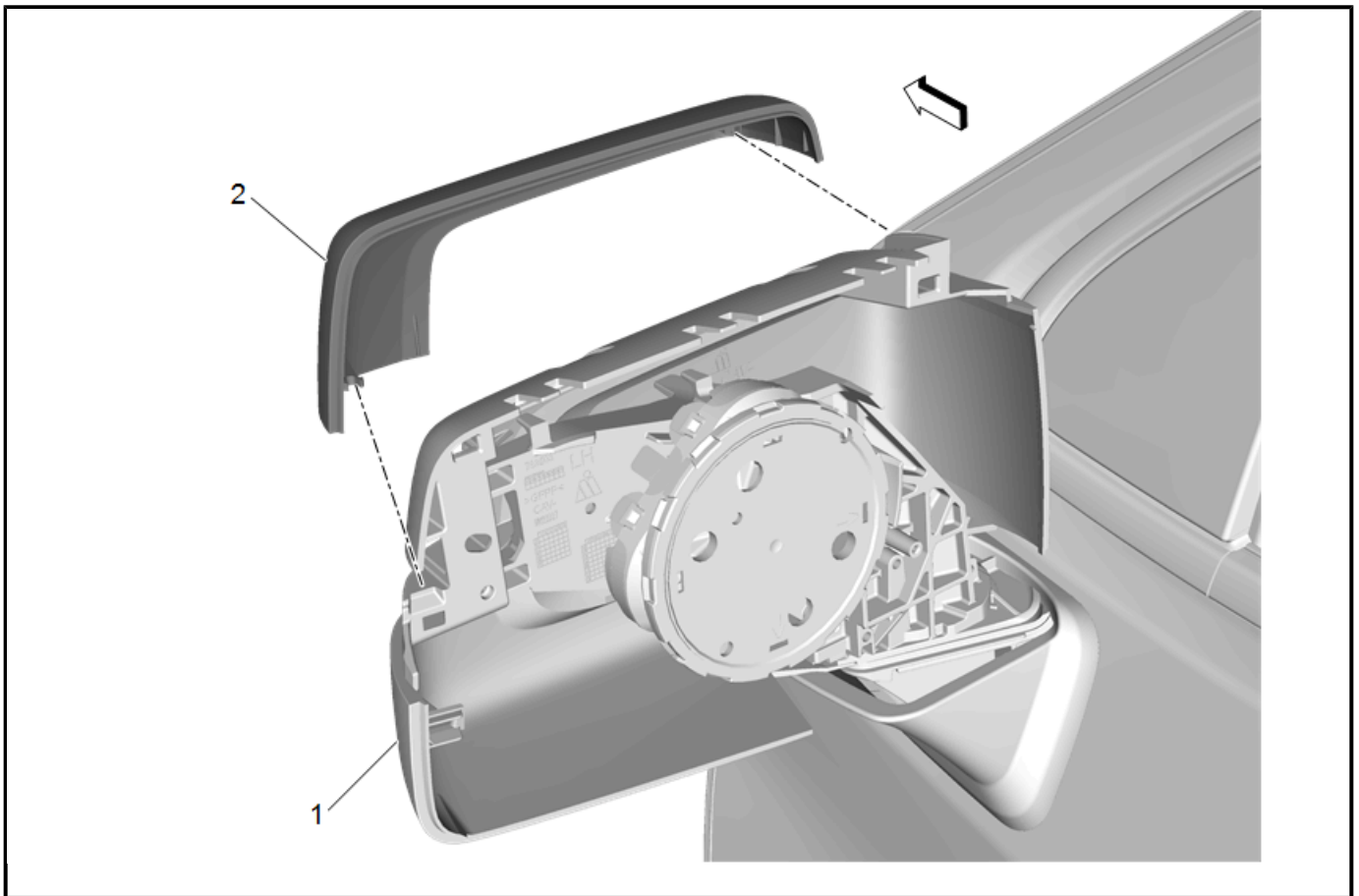

4986399

1. Align the new mirror housing cover (2) with the base of the outside mirror housing assembly (1), push forward until the housing cover is fully seated into housing engaging the retaining tabs.

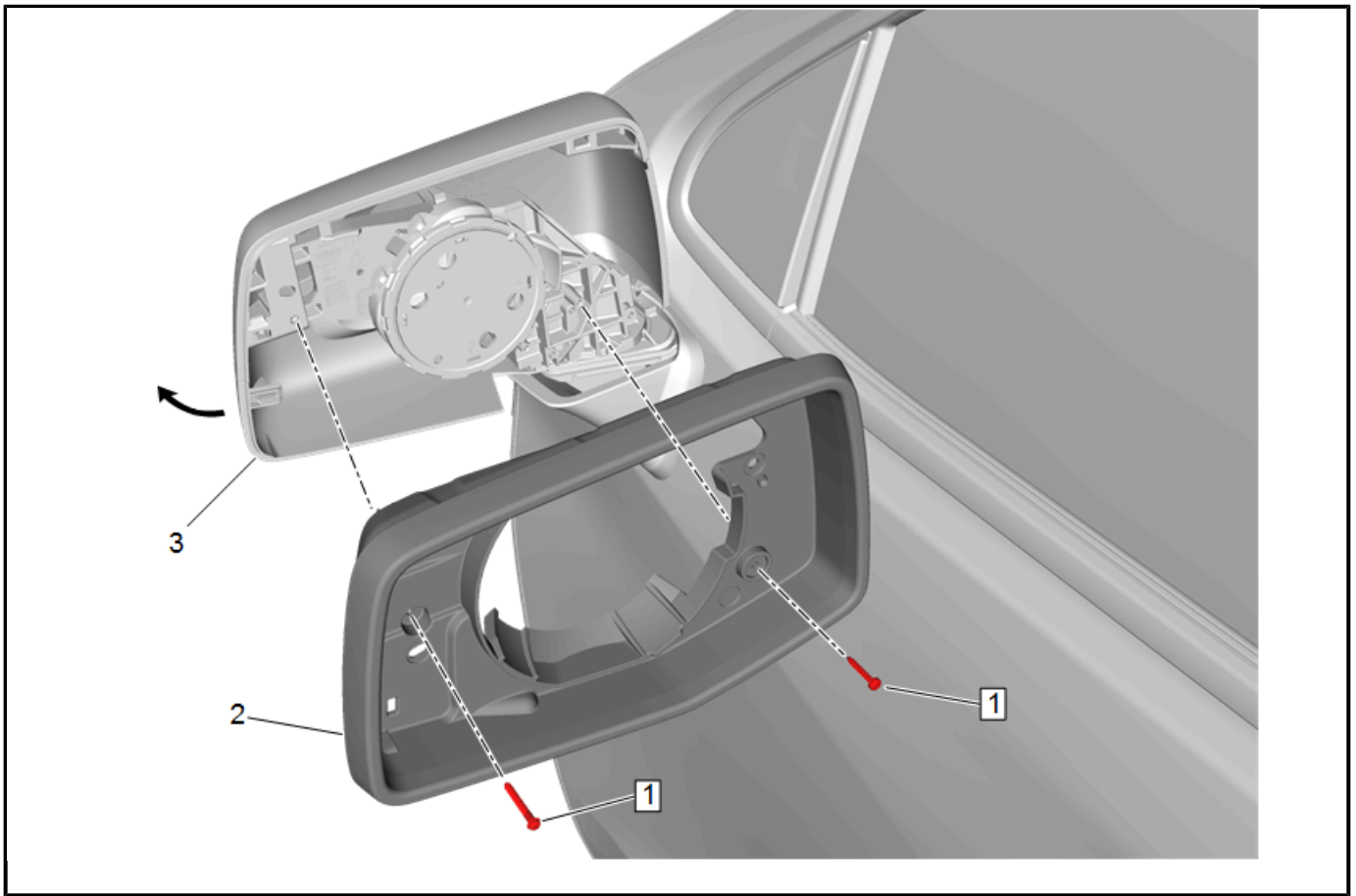

4986395

2. Install the bezel (2) to the mirror housing (3).

**Caution:** Use the correct fastener in the correct location. Replacement fasteners must be the correct part number for that application. Fasteners requiring replacement or fasteners requiring the use of thread locking compound or sealant are identified in the service procedure. Do not use paints, lubricants, or corrosion inhibitors on fasteners or fastener joint surfaces unless specified. These coatings affect fastener torque and joint clamping force and may damage the fastener. Use the correct tightening sequence and specifications when installing fasteners in order to avoid damage to parts and systems.

3. Install the previously retained two screws (1) to the bezel (2).

**Tighten**

2 N.m (18 lb in).

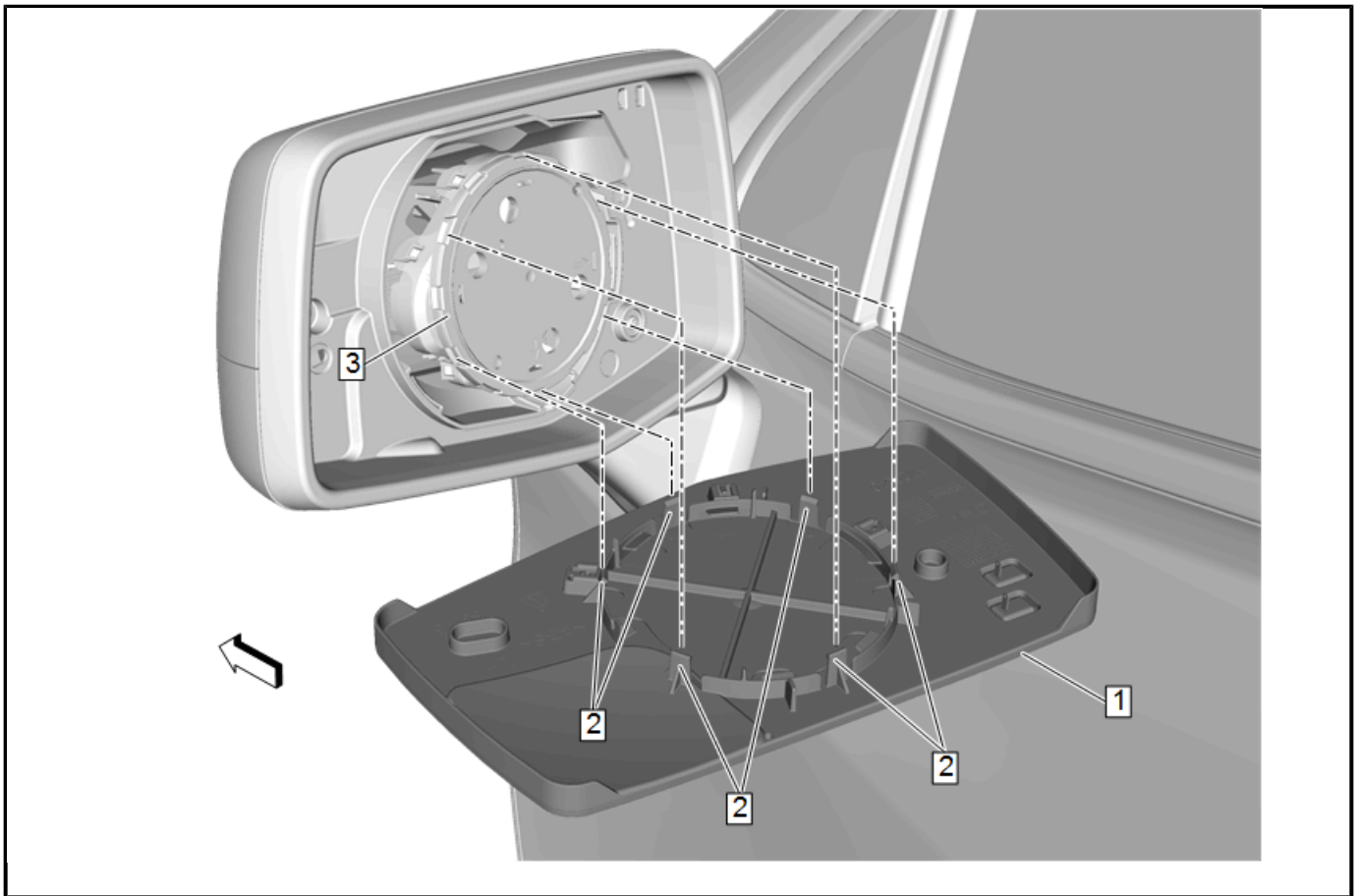

4986394

4. Position the mirror (1) to mirror housing and connect the electrical connectors.
  5. Place the mirror (1) on the lower mirror motor/actuator ring tabs (2).
  6. Place a suitable tool between the mirror glass and top of the housing.
  7. Press downward on the suitable tool, this will allow the mirror glass to lock on the tabs of the motor/actuator ring (3).
  8. Remove the masking tape from the lower edge of the mirror housing and mirror glass.
- Note:** Ensure all electrical connectors are properly connected.
9. Inspect the mirror for proper operation.