

Pickup Box Utility Rack Package Installation (Instruction ID:23144879)

Installation Instructions Part Number

23144879

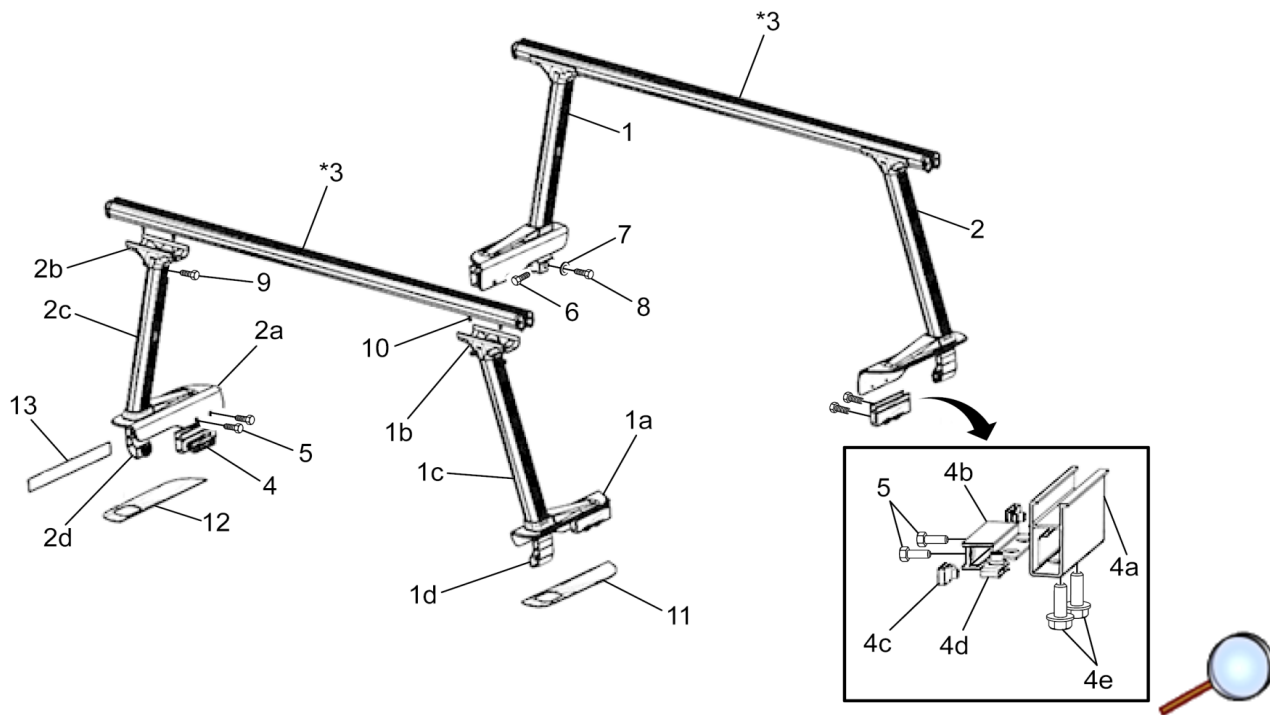

Kit Contents

Item Number	Part Number	Description	Qty
1	23463823	Stanchion Assembly (Driver Frt/Passenger Rr)	2
1A	-	Lower Casting	1
1B	-	Upper Casting	1

© 2018 General Motors. All rights reserved.

Item Number	Part Number	Description	Qty
1C	-	Stanchion	1
1D	-	Stake Pocket Bracket	1
2	23463822	Stanchion Assembly (Passenger FRT/Driver Rr)	2
2A	-	Lower Casting	1
2B	-	Upper Casting	1
2C	-	Stanchion	1
2D	-	Stake Pocket Bracket	1
3	22950523	*Tiered Storage Cross Rail (Sold separately)	2
AA	23144882	Hardware Kit	1
4	23463821	Clamp Assembly	4
4A	23463820	Vertical Clamp Bracket	1
4B	23483722	Horizontal Clamp Bracket	1
4C	11507067	M6 U-nut	2
4D	11516647	M8 U-nut	2
4E	11566789	M8 Hex Head W/Conical Washer	2
5	11548000	M6 Flat Head Bolt	8

Item Number	Part Number	Description	Qty
6	11516647	M8 U-nut (Stake Pocket Bracket)	4
7	20432548	Washer	4
8	11569789	M8 Hex Head W/Conical Washer	4
9	11546377	M8 Flange Nut	8
10	11547613	M8 Square Head Bolt	8
11	23272744	Foam Pad (Driver FRT/Passenger Rr)	2
12	23272743	Foam Pad (Passenger FRT/Driver Rr)	2
13	23272745	Foam Pad (Common Side)	4

Tools Required

- Utility Knife
- Torque Wrench with 13 mm socket
- 4 mm Allen socket/driver, or key
- 2-inch diameter hole saw bit (for installation with bed liner)

Note: This system has been designed with a 300 lb (136 kg) load capacity. Do not exceed the load limits.

Procedure

Note: For installation with a GM accessory bed liner, the Bed Liner must be removed from the pick-up box prior to install of the Utility Rack Assembly. When Utility Rack Assembly is complete, the Bed Liner can then be installed.

Bed Rail Preparation

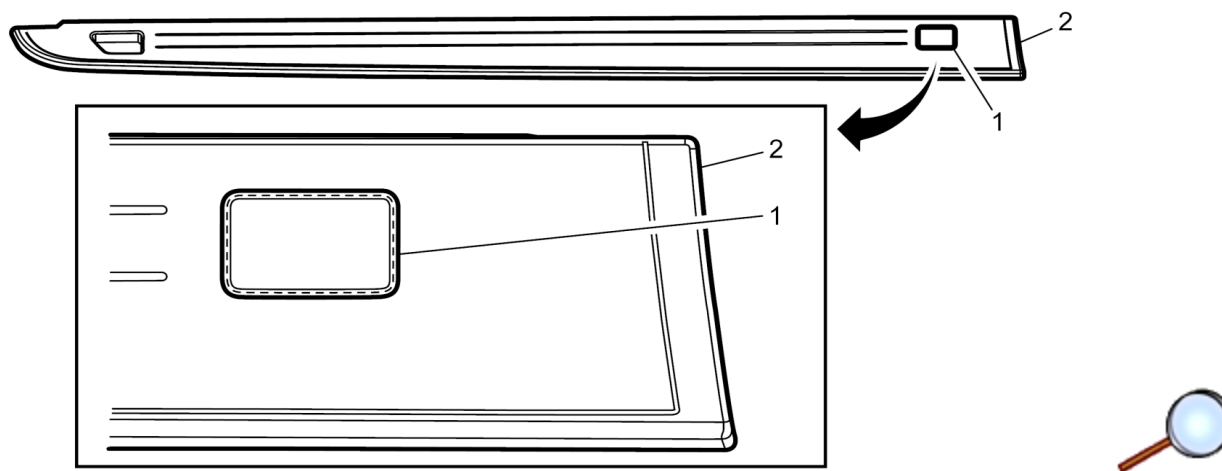

1. Remove the rectangular recess (1) in the bed rail molding (2) at both front stake pockets with a utility knife or similar cutting tool.
2. Dispose of the removed plastic.

Foam Pad Assembly

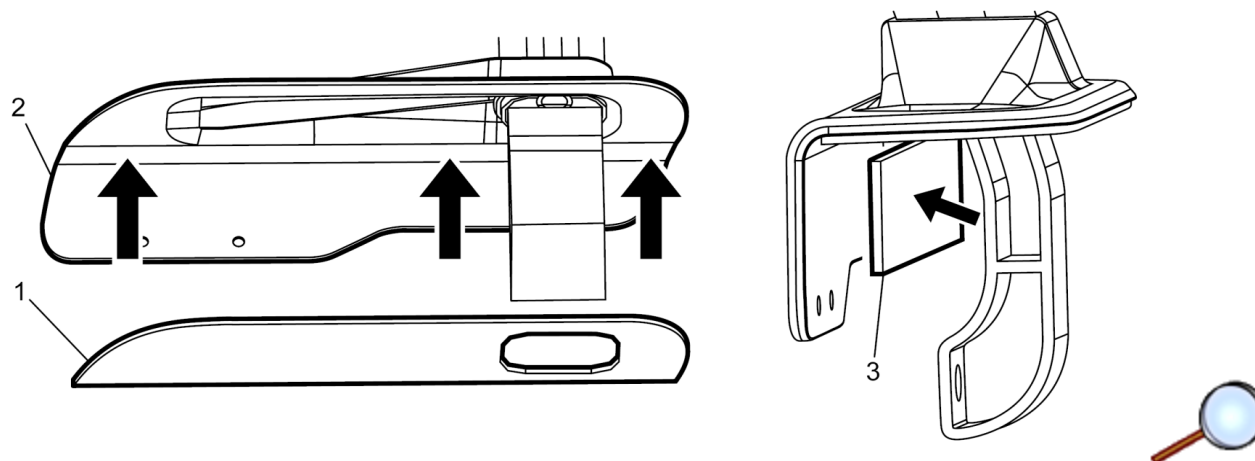

1. Ensure the underside surface of each stanchion assembly (2) (Items 1 & 2 in parts list) is clean of dust and debris. Peel the backing off the adhesive side of foam pad (1) (Item 11 or 12 in parts list) and apply to the underside of the lower casting (Items 1A & 2A in parts list), making sure to align all edges and apply pressure throughout to ensure adhesion.
2. Repeat for the side foam pad (3) (Item 13 in parts list) and apply foam pads to the remaining stanchion assemblies.

U-Nut Assembly

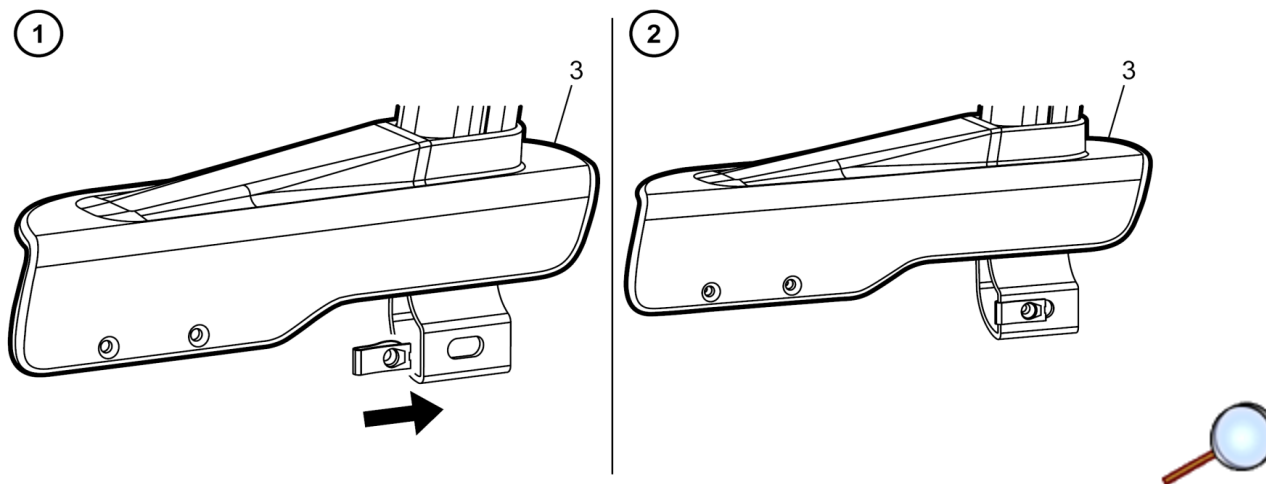

Note: Pictured above – Driver Side Front Stanchion & Passenger Side rear Stanchion Assembly (3).

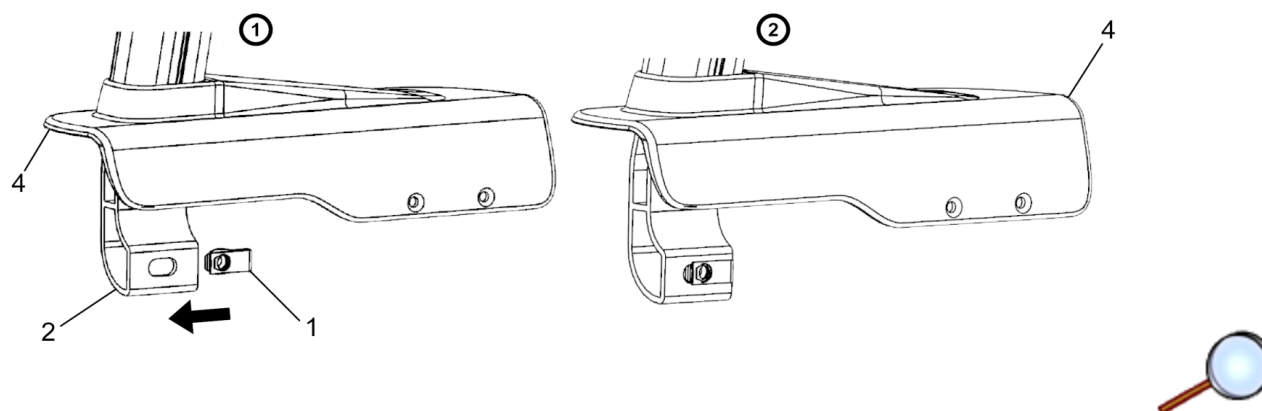

Note: Pictured above – Passenger Side Front Stanchion & Driver Side Rear Stanchion Assembly (4).

Slide the U-nuts (1) (Item 6 in parts list) from the hardware kit (Item AA in parts list) onto the stake pocket brackets (2) (Items 1D & 2D in parts list).

All U-nuts should be oriented at the interior edge of the stake pocket bracket as shown. Ensure the threaded side of the U-nut is oriented inside of the stake pocket bracket, so that the stake pocket bracket can sit flat against the inside of the stake pocket during assembly.

Stanchion Attachment

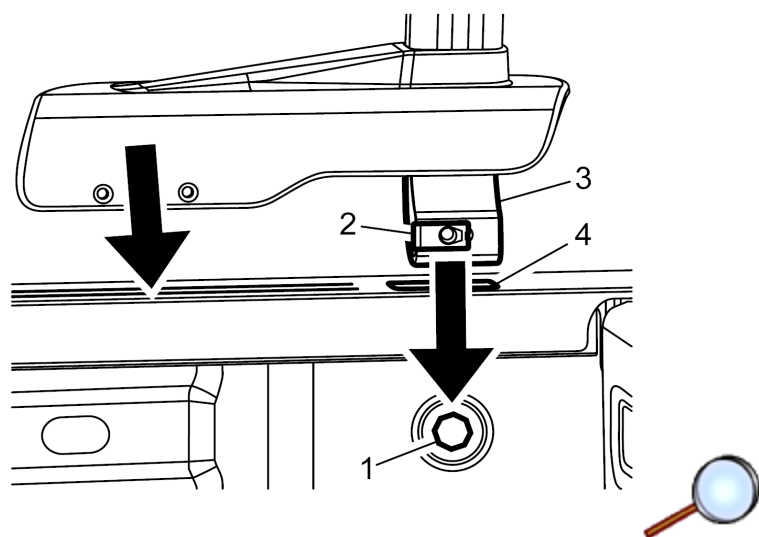

1. Standing inside the truck bed, carefully install any stanchion assembly (3) (Item 1 or 2 in parts list) into the stake pocket opening (4). It may be required to tilt the stanchion assembly inward to clear the side of the bed wall during assembly and /or disassembly. The pad on the underside of the lower casting will rest flat against the bed rail molding. Ensure the stake pocket bracket U-nut (2) aligns with the stake pocket hole (1) in the bedside.

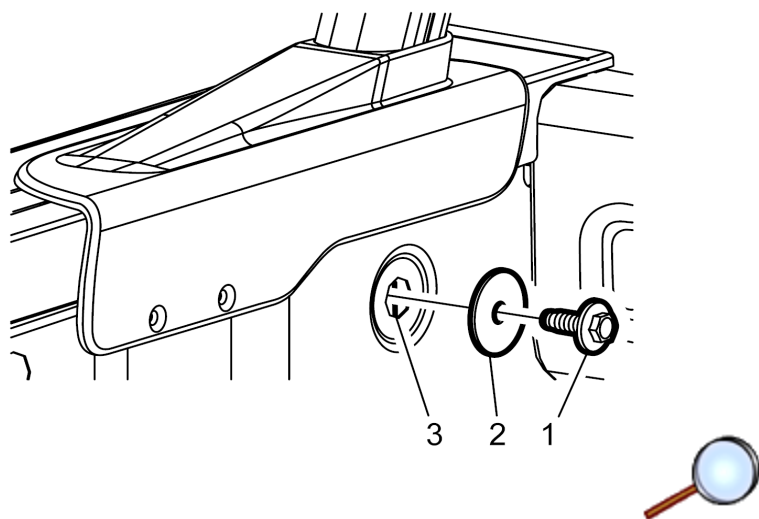

2. Insert washer (2) (Item 7 in parts list) onto the stake pocket fastener (1) (Item 8 in parts list), insert through the hole (3) in the side bed wall, and hand tighten into the U-nut until the stanchion assembly is able to retain its upright position.

3. Repeat for opposing side.
4. Repeat previous steps for remaining stanchions.

Cross Bar Assembly

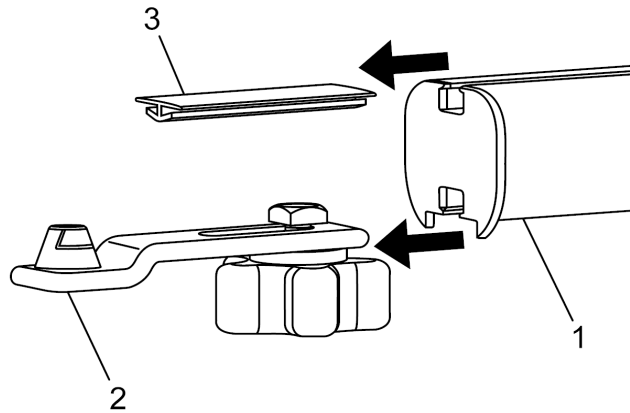

1. Prepare the tiered storage cross bars (1) (P/N 22950523) for assembly to the stanchions by removing and setting aside the anchor plate assembly (2) and protective rubber strip (3). Save the removed components for installation of the multifunctional, tiered storage to the pick-up box tie downs at a later date.

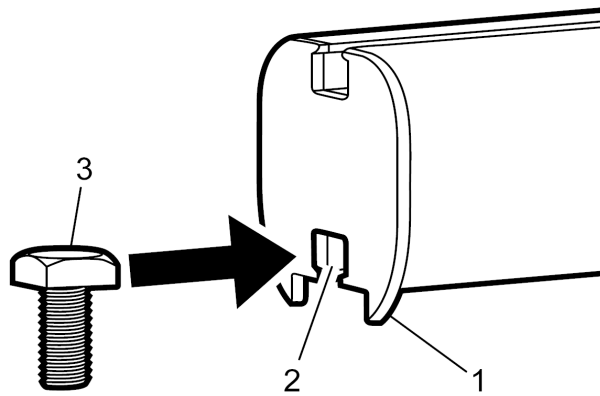

2. With the cross bar end caps (1) pointed down, slide two of the square head bolts (3) (Item 10 in parts list) into the lower T-slot channel (2) on each end of the cross bar and align with the holes in the upper casting (Item 1B or 2B in parts list).

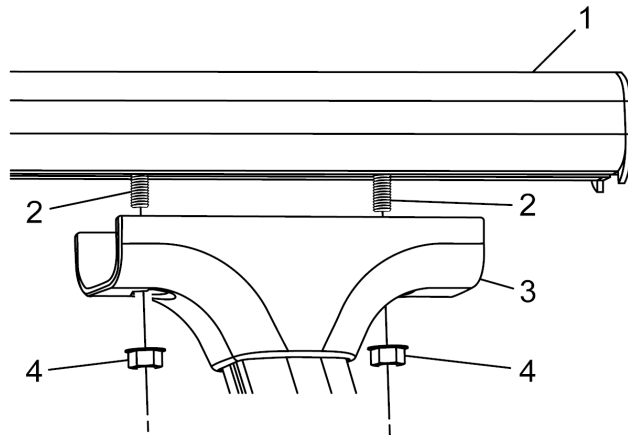

3. With the bolts (2) aligned properly with the upper casting holes, push the cross bar (1) down onto the upper casting (3) one side at a time, so it seats securely.
4. Loosely install the nuts (4) (Item 9 in parts list) onto the fasteners to allow for cross bar adjustment in the next step.

5. With a tape measure, make sure the cross bar is centered side to side between the two stanchions assemblies. Make sure the stanchions are tight to the sides of the bed rails. The foam pad on the sides of the lower casting should be as close to the bed rails as possible.
6. Hand tighten all four cross bar nuts. Final torque of 22 N.m (16 lb ft).
7. Torque the stake pocket fasteners to 22 N.m (16 lb ft).
8. Repeat previous steps for remaining stanchions.

Clamp Assembly

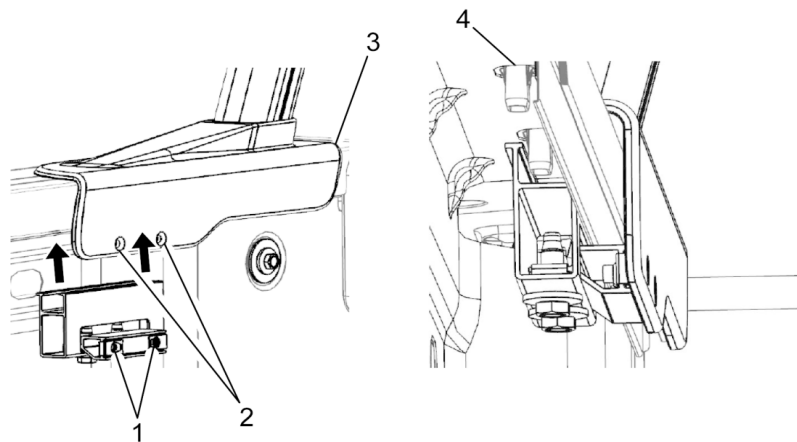

1. Align the clamp assembly (Item 4 in parts list) U-nuts (1) in the horizontal clamp bracket with the two holes (2) in the lower casting of any of the four stanchion assemblies (3). The vertical clamp bracket (Item 4A in parts list) legs should sit flat against the underside of the bed rail sheet metal and clear the bed rail molding clips (4).

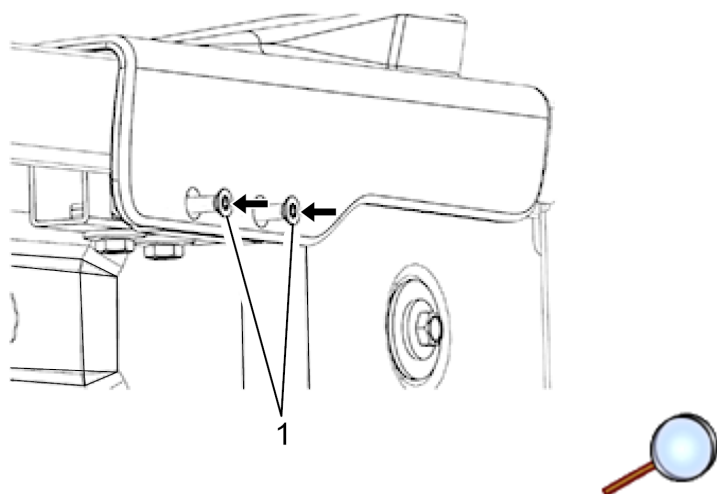

2. With the vertical clamp bracket in place against the underside of the bed rail sheet metal, install the M6 flat head fasteners (1) (Item 5 in parts list) through the lower casting holes into the horizontal clamp bracket U-nuts.
3. Torque the M6 flat head fasteners to 9 N.m (7.0 lb ft)

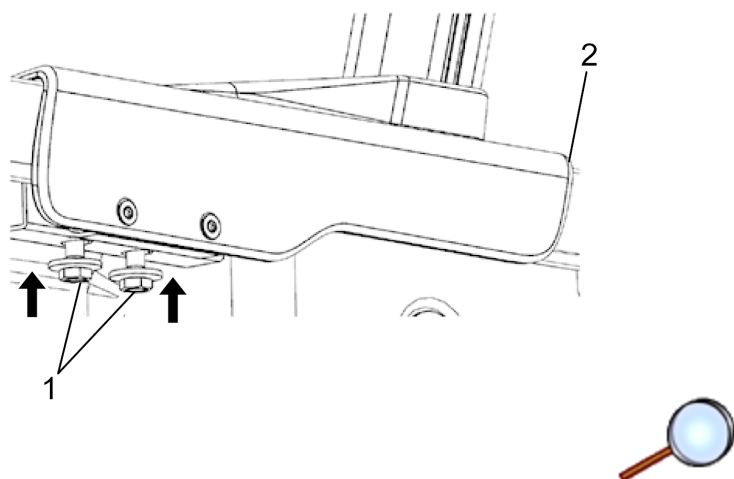

4. Torque the two vertical clamp bracket bolts (1) (Item 4E in parts list) to 22 N.m (16 lb ft). The stanchion assembly (2) should now be tightly clamped to the bed rail.
5. Repeat previous steps for the remaining stanchion assemblies.

6. Inspect all fasteners to ensure they are properly torqued and utility rack assembly is ready for use.
7. It is advised to inspect all fasteners regularly to ensure utility rack is installed properly and safe for use.